

# SPOTT 2.0

LED SUBMERSIBLE

TYPE:

PROJECT NAME:



## SPOTT 2.0 Dimensions

L5PW20

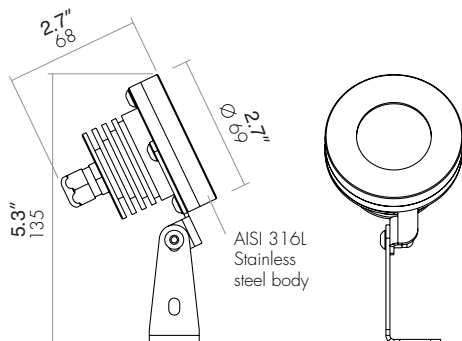

L5PW20	-	-	-	-	I	-
MODEL #	WATT	LED	OPTICS	FINISH	VOLTAGE	

## DESCRIPTION:

Adjustable spotlight constructed entirely in aisi 316L stainless steel. may be installed to a depth of up to 3m. provided with 5 m. of neoprene wiring. A more technical version with 3 LEDs with RGB is also available. The mounting bracket is adjustable and allows for a wide rotation. suitable for corrosive environments.

## INSTALLATION NOTE:

Must be wired in series when two or more are wired together with same driver.

## SPOT LIGHT

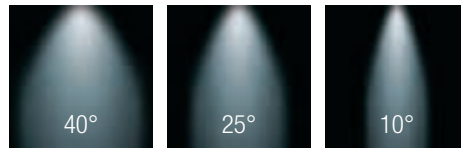

## LED COLORS

- |                                      |                               |
|--------------------------------------|-------------------------------|
| <input type="radio"/> 0. 5000K WHITE | <input type="radio"/> 1. BLUE |
| <input type="radio"/> 5. 3000K WHITE | <input type="radio"/> 6. RGB  |

## FINISH

- ☐ I. INOX

WATTAGE ☐ 3W ☐ 6W

VOLTAGE ☐ 120V ☐ 220V ☐ 277V

## OPTICS

- ☐ L. 40° ☐ M. 25°  
☐ S. 10°

# SPOTT 2.0

LED SUBMERSIBLE



LEDOLOGY®

A **Luminart** BRAND

[WWW.LUMINARTLIGHTING.COM](http://WWW.LUMINARTLIGHTING.COM)