

BORNE BÉTON GRAND

Le Corbusier

CODE#

TYPE:

PROJECT NAME:

Concrete outdoor and indoor floor and table lamp, conceived for the
Unité d'habitation de Marseille and for Bhakra Dam, Sukhna Dam in India in 1952.



SPECIFICATION SHEET

Luminart[®]

WWW.LUMINARTLIGHTING.COM

BORNE BÉTON GRAND

Le Corbusier

CODE#

TYPE:

PROJECT NAME:

LED outdoor IP44

Lamping

Source	LED board
Total power	38,4W
Emission	direct
Dimming	dimnable
Voltage	110/240V
Color temperature	3000K
Luminous flux Typ	3840lm
cri	80
Energy class	A+
Ip class	44

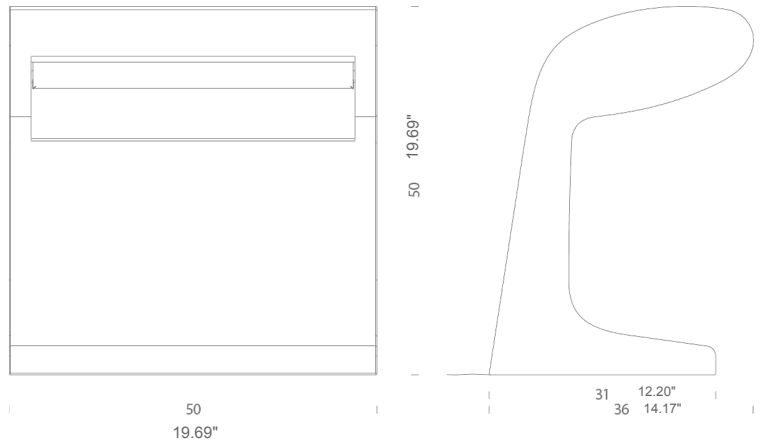

Codes

BBG LDW 21

Structure

concrete

Diffuseur

Package

LxPxH (base)	23.62x17.72x23.62"
Weight	116.6 lbs

SPECIFICATION SHEET

BORNE BÉTON GRAND

Le Corbusier

CODE#

TYPE:

PROJECT NAME:

LED indoor

Lamping

Source	LED board
Total power	38,4W
Emission	direct
Dimming	dimnable
Voltage	110/240V
Color temperature	3000K
Luminous flux Typ	3840lm
cri	80
Energy class	A+

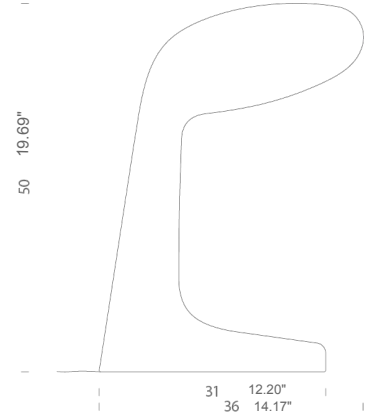
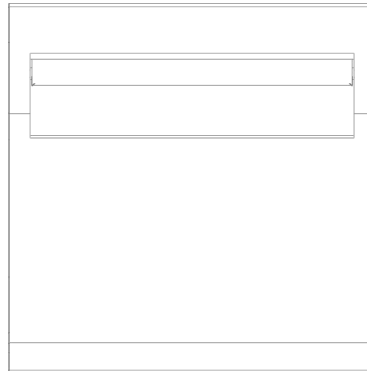

Codes

BBP LDW 21

Structure

concrete

Diffuseur

Package

LxPxH (base)	23.62x17.72x23.62"
Weight	116.6 lbs

SPECIFICATION SHEET