

ALCO SUSPENSION

SINGLE CABLE OPTION INSTALLATION SHEET

FINISHES

-  Kvadrat
-  Soft textile

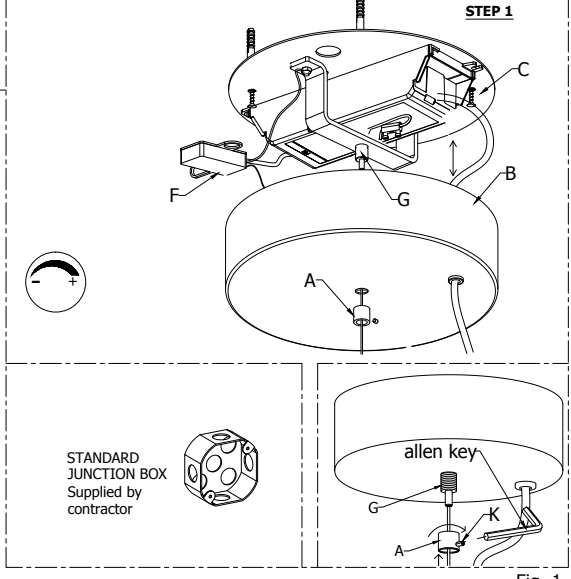
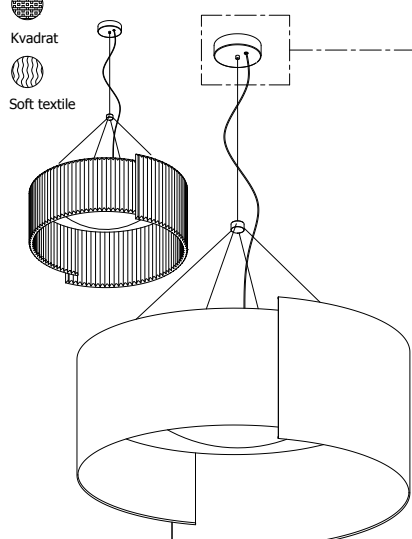

STANDARD JUNCTION BOX
Supplied by contractor

Fig. 1

STEP 2

FIX COVER

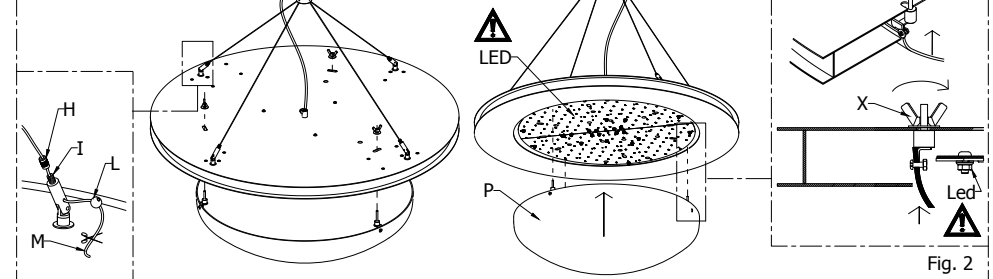

Fig. 2

STEP 3

FIX THE PANELS

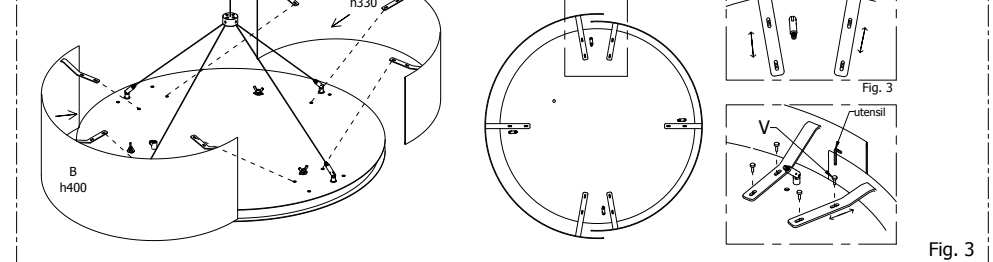

Fig. 3

INSTRUCTIONS

- Disconnect the power source.

STEP 1

- Unscrew the decorative nut (A) and lower the canopy (B). (Fig.1)
- Fix the metal backplate (C) to ceiling junction box (junction box supplied by contractor)(please ensure the installation of both the junction box and light fixture is reinforced to support the weight of the Alco fixture on the ceiling.) (FIG.1)
- Adjust the length of the steel cable acting on regulating terminal security (G), push the part (B) of the gripper so that the steel cable runs. (Fig.1)
- Make wiring connections to the LED driver (F) according to the polarity. (Fig.1)
- DIAGRAM OF CONNECTIONS see attached sheet
- Adjust the power cable to the required length, it doesn't have to be too tense.
- Raise the canopy in the ceiling. Secure it in position with decorative nut (A) to the cable gripper thread (G). (Fig.1).
- Screw the safety screw (K) (Fig.1).

STEP 2

- If necessary, regulate the structure by loosening the screw of the safety cable gripper lock screw (L), unscrew the detail (H), regulate the steel cable (M) by pressing the detail (I) and then close again the detail (H). Replace the safety cable gripper lock screw (L) and screw the screw. Cut the cable in excess (Fig. 2).

STEP 3

- Insert the dome (P) in the central hole of the frame, inserting the pins (W) into the slots, tighten the nuts (X). (Fig.2)
- Fix the panels A and B with the appropriate screws (V) (Fig.3)

ATTENTION

The products of our production are suitable for the using in usual surroundings with standard temperature and humidity levels. All the operations have to be done by a licensed electrician.

CLEANING

Switch off the power. For the periodical cleaning of the lamp use always gloves and a soft cloth or a feather duster. **Don't use aggressive solvents or alcohol.**

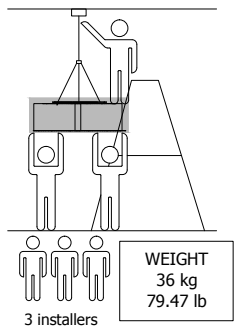

Phase Dimming	
green-yellow GROUND	1
black PHASE	2
white NEUTRAL	3

0-10V Dimming	
green-yellow GROUND	1
black PHASE	2
white NEUTRAL	3
D1	4
D2	5

INSTALLATION SHEET

