

# TRIBES™ 3

INSTALLATION SHEET



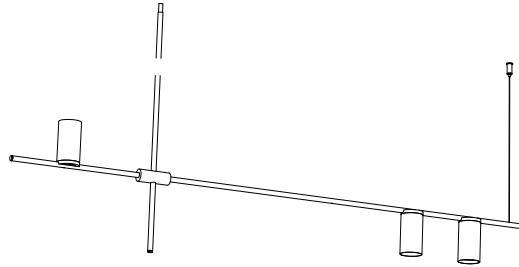

TYPE:

PROJECT NAME:

## tribes 3



### tribes 3

LED		2700K	120V	9x7W			
-----	---	-------	------	------	---	---	---

black painted  
white painted  
black painted/24K gold  
white painted/24K gold

INSTALLATION SHEET

**Luminart®**

WWW.LUMINARTLIGHTING.COM  
Last updated: 6/25/19

# TRIBES™3

## INSTALLATION SHEET

TYPE:

PROJECT NAME:

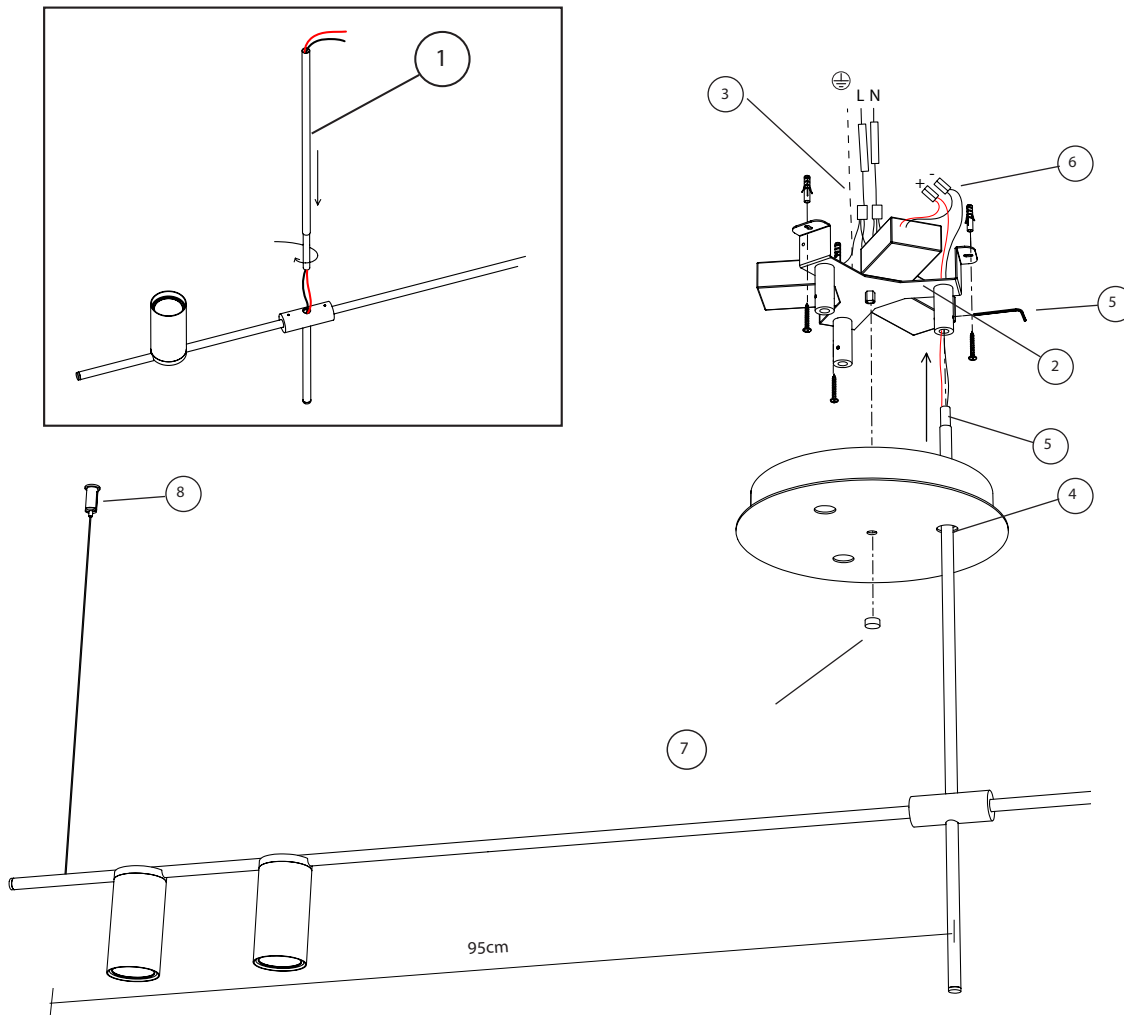

We advise not to unwrap the tribes completely during the installation to prevent scratches.

- 1: fix the tube on the cilinder and tighten firmly. Be carefull not to damage the wires.
- 2: fix the bracket on the ceiling with the supplied screws.
- 3: connect drivers to the AC mains voltage.
- 4: fit tribes through the ceiling canopy. **IMPORTANT:** start with the shortest tribes!
- 5: fit the wires and the threaded end trough the tube on the bracket and fix with the hex key.
- 6: connect the wires to the driver.
- 7: fix the ceiling canopy with the provided screw button.
- 8: Attach the steelcable to the ceiling. The distance is 95cm from the center of the vertical tube. Adjust the steelcable untill the tribes are horizontal.

**General installation and maintenance directives concerning factory guarantee.** Connecting and testing the lamps must always happen by an acknowledged electrician according to the locally applying regulations on electric installations. Do not place on a flammable surface. All class I lamps must be earthed in the cable clamp marked with a Ⓢ-sign. Class II lamps may not be earthed. Disconnect from the main supply when fitting lamp or changing bulb. This lamp satisfies to the low tension directive 73/23/EEG with modification 93/68/EEG and the EMC directive 89/336/EEG with modifications 92/31/EEG and 93/68/EEG.