

Mork

Art. 1506
max 1400 mA - 3,4W DC - 3000 K

Legend:

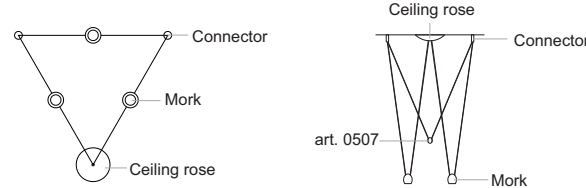

Examples of in line configuration

2 MORK

2 art. 1506
Mork (connector included)
+
1 art. 0506
Ceiling rose
+
1 art. 0507
Accessory for linear configuration
2, 4 or 6 Mork.



Examples of geometric configuration

3 MORK

3 art. 1506
Mork (connector included)
+
1 art. 0506
Ceiling rose

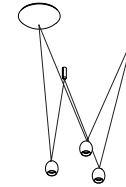
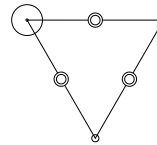

3 MORK

3 art. 1506
Mork (connector included)
+
1 art. 0506
Ceiling rose

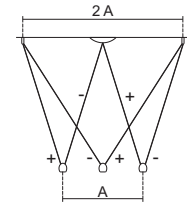

4 MORK

4 art. 1506
Mork (connector included)
+
1 art. 0506
Ceiling rose

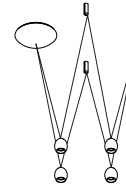
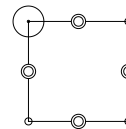

4 MORK

4 art. 1506
Mork (connector included)
+
1 art. 0506
Ceiling rose
+
1 art. 0507
Accessory for linear configuration
2, 4 or 6 Mork.

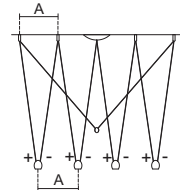

5 MORK

5 art. 1506
Mork (connector included)
+
1 art. 0506
Ceiling rose

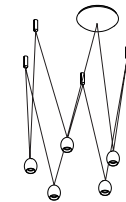
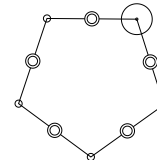

5 MORK

5 art. 1506
Mork (connector included)
+
1 art. 0506
Ceiling rose

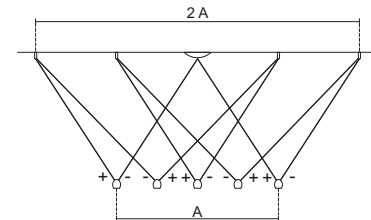

6 MORK

6 art. 1506
Mork (connector included)
+
1 art. 0506
Ceiling rose

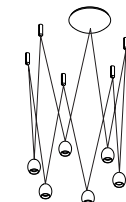
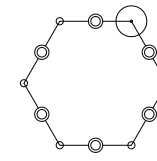

6 MORK

6 art. 1506
Mork (connector included)
+
1 art. 0506
Ceiling rose
+
1 art. 0507
Accessory for linear configuration
2, 4 or 6 Mork.

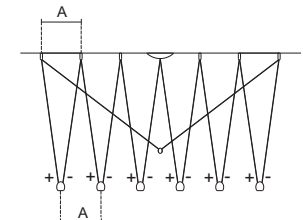

	Class III luminaire.
	Fixture ready for mounting on normally inflammable surfaces.
	RAEE Symbol (Waste Electrical and Electronic Equipment). The use of the RAEE symbol indicates that this product may not be treated as household waste. By ensuring this product is disposed of correctly, you will help protect the environment. For more detailed information about the recycling of this product, please contact your local authority, your household waste disposal service provider or the shop where you purchased the product.

This equipment is guaranteed only if used as indicated in these instructions; preserve this instructions.
Before any operation on this equipment, disconnect the power supply. Installation must be made by qualified persons. For a correct assembling see the here enclosed diagram. In order to grant a constant current, all leds must be connected in series, an eventual parallel connection commonly used for halogen lamps destroys the leds in a short time. Power supply cable of the device cannot be replaced, if the cable has been damaged the entire device shall be replaced immediately. This product contains a light source of energy efficiency class F.

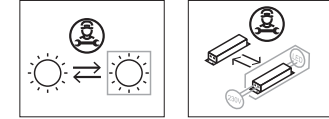

Installation with central ceiling rose

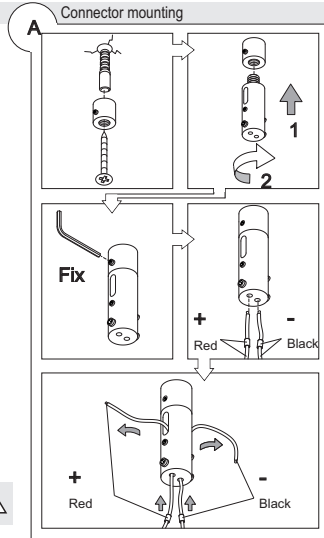
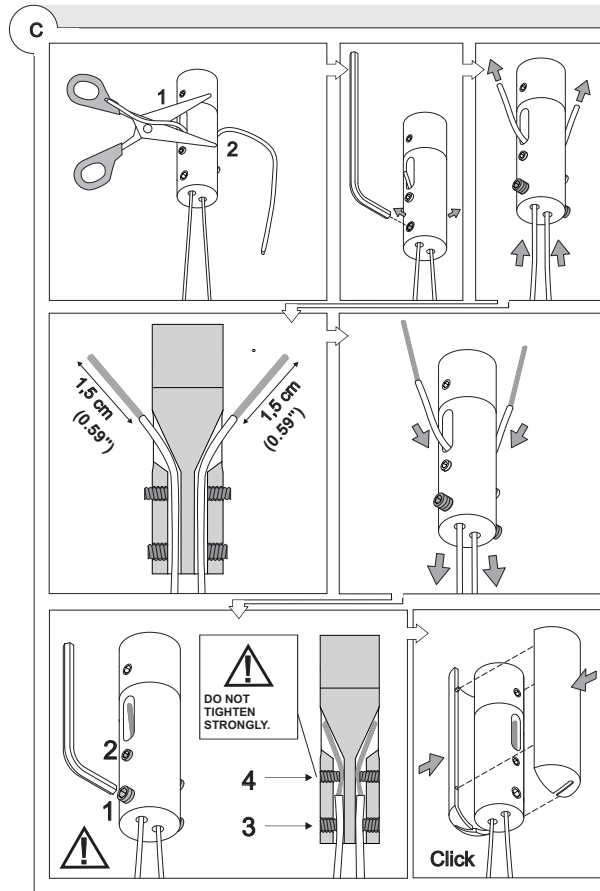
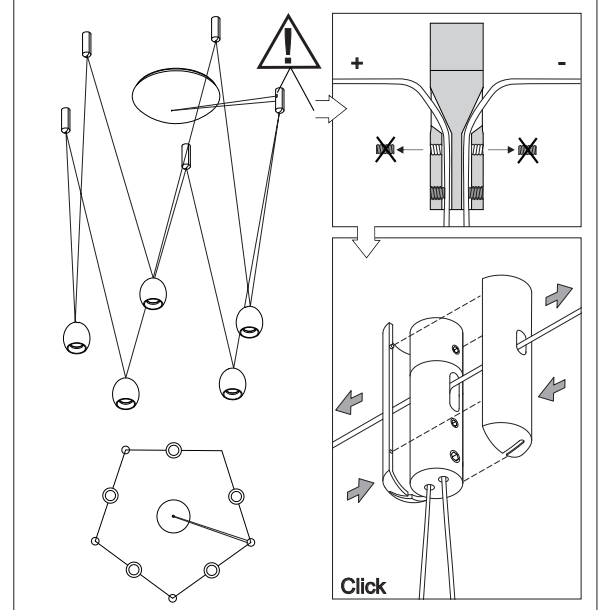

⚠ ONLY SERIAL CONNECTION ⚠

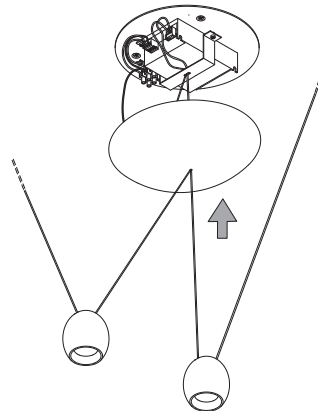
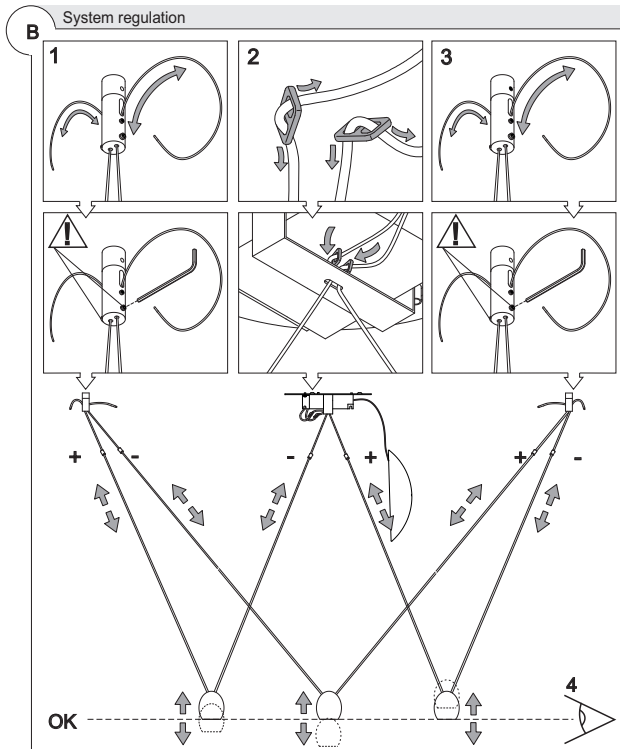

MORK™ 0506

CEILING ROSE WITH CONVERTER

TYPE:

PROJECT NAME:

To avoid damages to LED unit all connection shall be made before to switch power on
Respect correct polarity when connecting



max setting driver 1050ma

Mork

Art. 0506

max 6 Mork
Ceiling rose with converter

This equipment is guaranteed only if used as indicated in these instructions: preserve this instructions. **Before any operation on this equipment, disconnect the power supply.** Installation must be made by qualified persons. For a correct assembling see the here enclosed diagram. In order to grant a constant current, all leds must be connected in series, an eventual parallel connection commonly used for halogen lamps destroys the leds in a short time. Power supply cable of the device cannot be replaced, if the cable has been damaged the entire device shall be replaced immediately. Not dimmable.

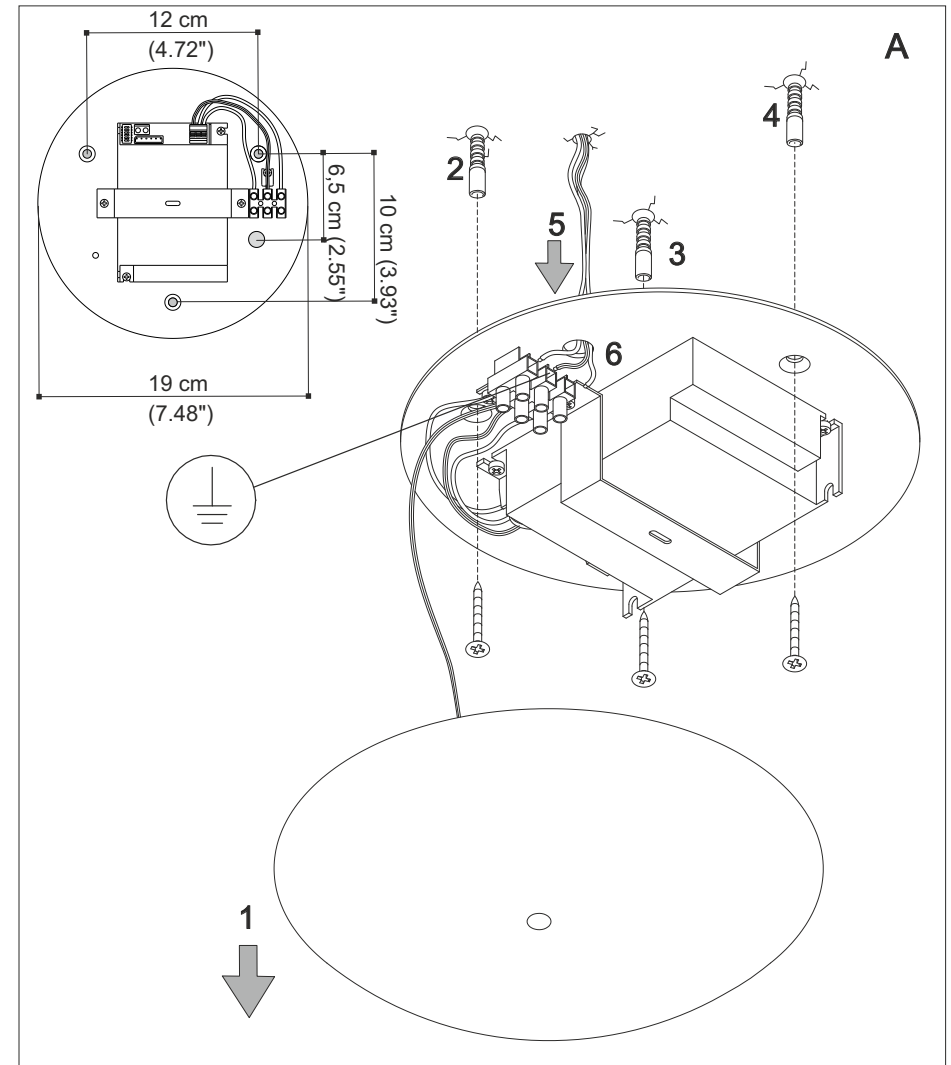



MORK™ 0506

CEILING ROSE WITH CONVERTER

TYPE:

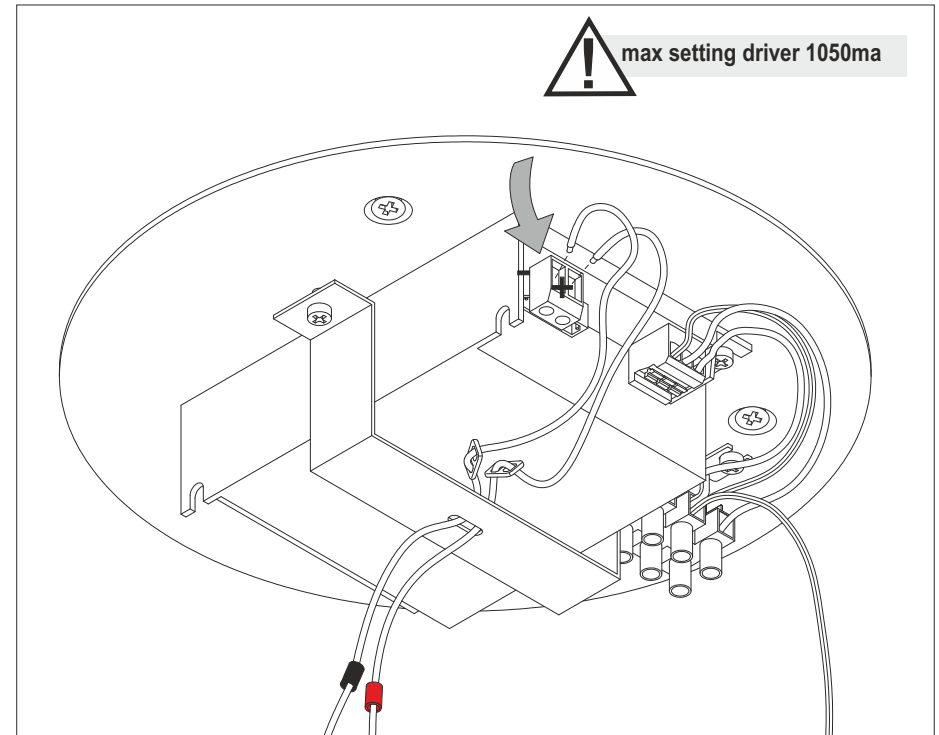
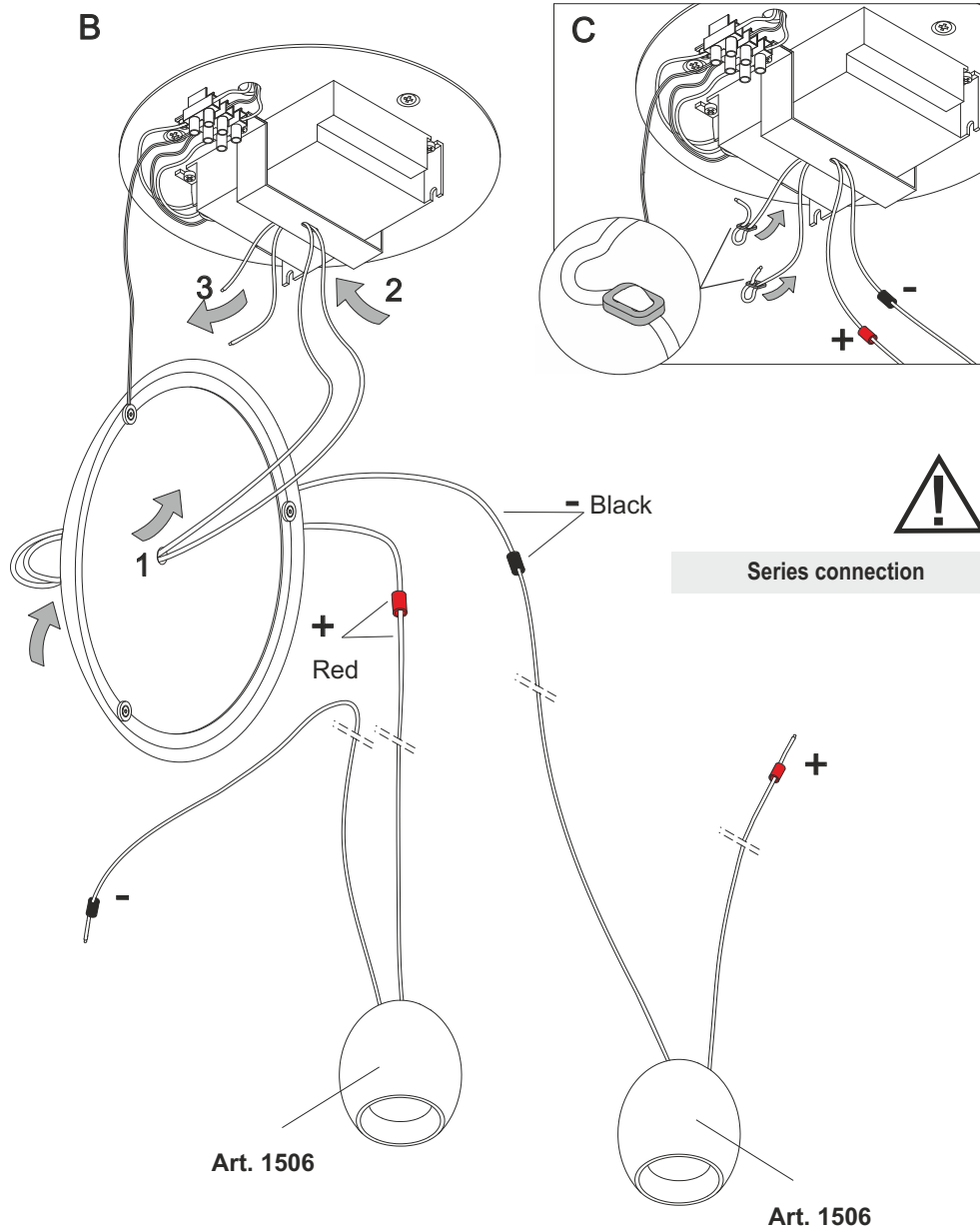
PROJECT NAME:



	This product must not be discarded as the responsibility of the City sanitation department, it must be gathered together separately and discarded.
	Fixture ready for mounting on normally inflammable surfaces.

INSTALLATION SHEET

MORK™ 0507

ACCESSORY FOR 2, 4, 6 MORK

TYPE:

PROJECT NAME:

Mork

Art. 0507

Optional for linear configuration 2, 4 or 6 Mork.

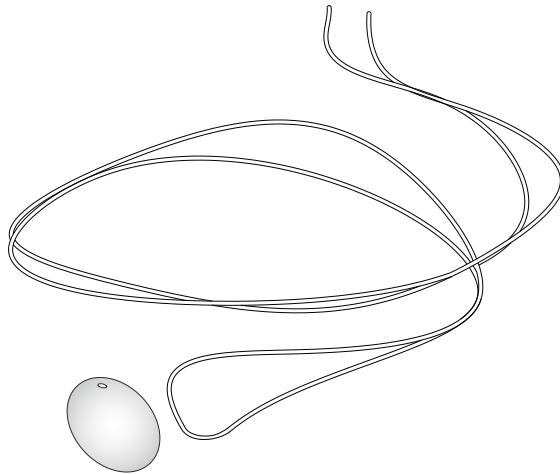

INSTALLATION SHEET

Examples of in line configuration

2 MORK

2 art. 1506
Mork (connector included)
+

1 art. 0506
Rosone - Ceiling rose
+

1 art. 0507
Accessory for linear configuration
2, 4 or 6 Mork.

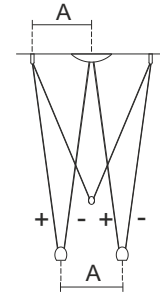

4 MORK

4 art. 1506
Mork (connector included)
+

1 art. 0506
Rosone - Ceiling rose
+

1 art. 0507
Accessory for linear configuration
2, 4 or 6 Mork.

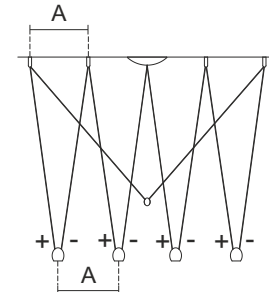

6 MORK

6 art. 1506
Mork (connector included)
+

1 art. 0506
Rosone - Ceiling rose
+

1 art. 0507
Accessory for linear configuration
2, 4 or 6 Mork.

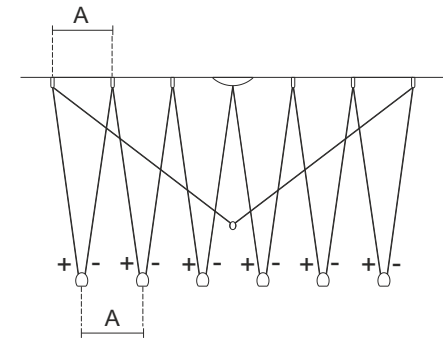

MORK™ 0507

ACCESSORY FOR 2, 4, 6 MORK

TYPE:

PROJECT NAME:

A

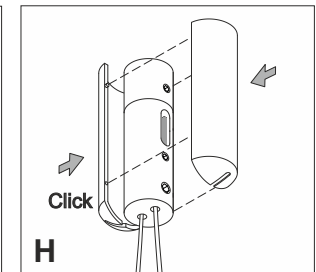
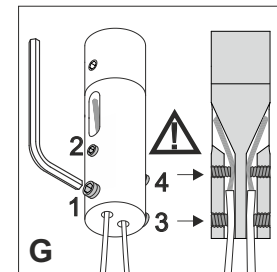
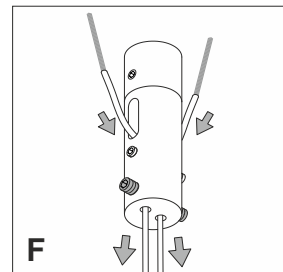
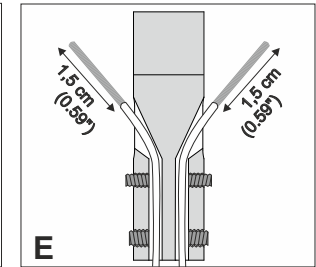
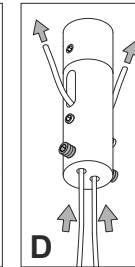
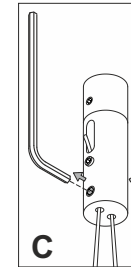
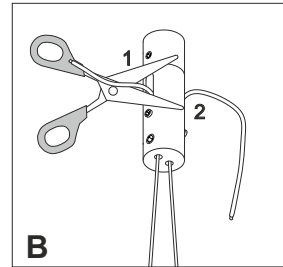
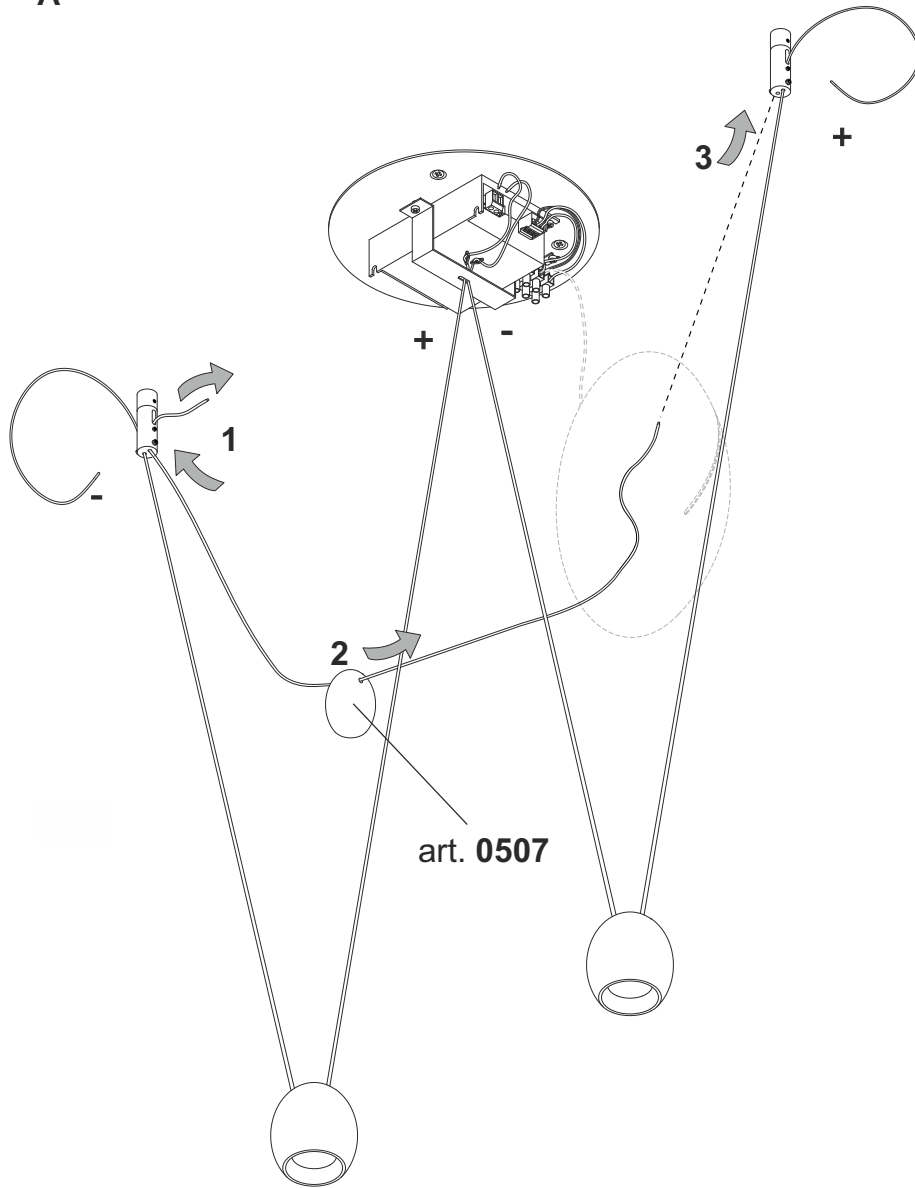

I

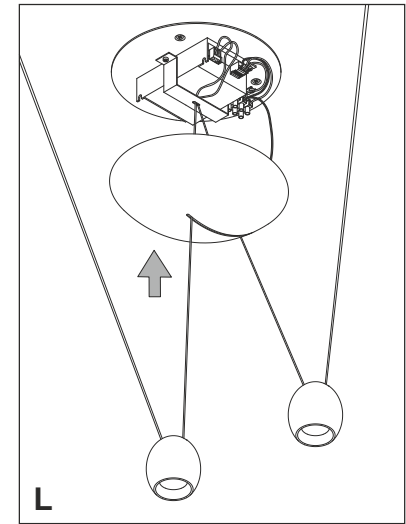
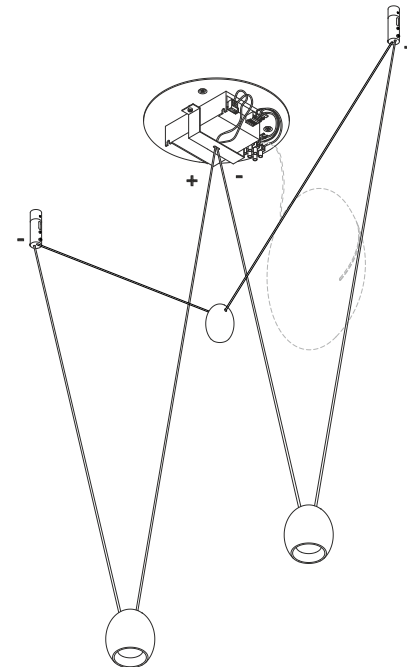

INSTALLATION SHEET