

Fig. 1

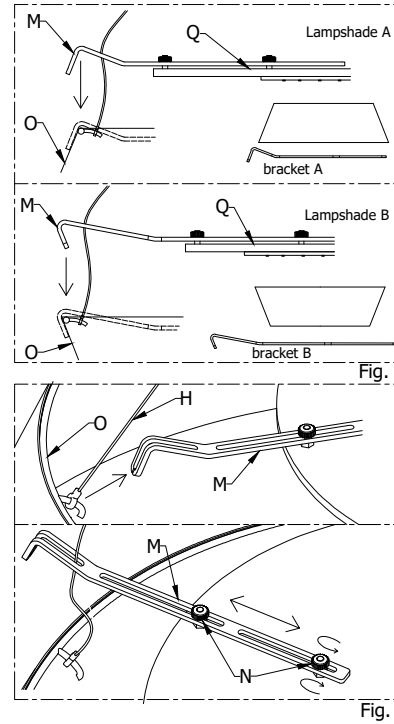

Fig. 2

Fig. 3

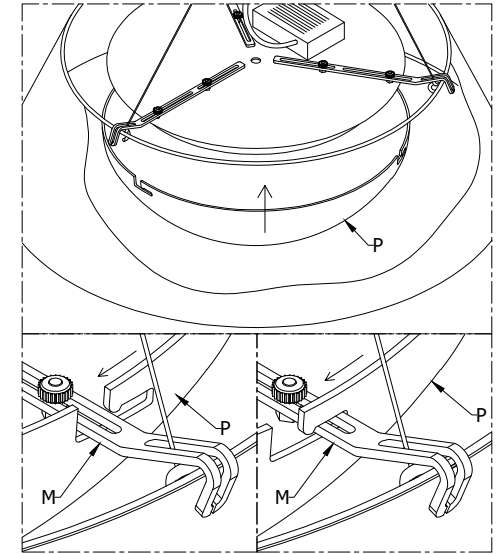

Fig. 4

Fig. 5

INSTRUCTION

- Disconnect the power supply.
- Fix the bracket (A) with screws (B) and plugs (C) to the ceiling (Fig. 1).
- Connect the mains cables to terminal (E) respecting the polarity and close the box (D) (Fig. 1).
- Version Dimmable connect the cables inside the box (V) matching the polarity (Fig. 1).
- DIAGRAM OF CONNECTIONS see sheet.
- Fix the rose (G) by screwing the screws (F) and the washers (J) to the bracket (A).
- Hook the three steel cables (H) to the rose (G) (Fig. 1).
- To adjust the height of the lamp, unscrew the dowel (I) of the cable locking cylinder (L); adjust the length of the cable, then close the grub screw (I) and cut the excess cable (Fig. 1).
- Insert the cable (H) inside the opening of the bracket (M); repeat the operation for all three cables (Fig. 2).
- Unscrew the nuts (N) and adjust the position of the brackets (M), the correct position of the brackets (M) is as shown (Fig. 3).
- Lock the brackets (M) by screwing the nuts (N) and rest the lamp holder plate (Q) on the lampshade (O).
- Check that the structure is perfectly centered and aligned.
- Position the lower cap (P) on the three brackets (M) through the openings present (Fig. 4-5).
- Make sure the cover fits perfectly on all three brackets. (Fig. 4-5).

ATTENTION

The products of our production are suitable for the using in usual surroundings with standard temperature and humidity levels. All the operations have to be done by a technician.

CLEANING

Switch off the power or pull the plug out.

For the periodical cleaning of the lamp use always gloves and a soft cloth (for glossy surfaces) or a feather duster for the lampshade in fabric or pleated fabric. Don't use aggressive solvents or alcohol. Avoid absolutely to fold parts which are not expected for folding, in this case welded parts are going to be damaged.

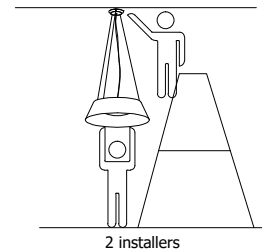

2 installers

WEIGHT
Kg 7 / 15.40 lb