

T-LUX™ OLLIE

BOLLARD

TYPE:

PROJECT NAME:



Bollard with brio

In the coupling between the Ø 120 mm (4.72") pole and the Ø 150 mm (5.9") upper disc OLLIE defines its lighting and aesthetic quality, which finds its maximum expression in the connection cone - a solid bollard that maintains a lightness of style.



Character in the composition

The choice of character that OLLIE can take on also becomes versatile, with a combination of two-tone or solid color finishes, to accentuate the light or discreetly fit into different contexts.

Photo-etched polycarbonate **diffuser** to prevent horizontal glare and to grant high output downwards.

Dissipating **upper disc** in die-cast aluminum with low copper content; the particular convex shape avoids water stagnation.

Cone in die-cast aluminum with low copper content; higher light diffusion in the aluminum gray finish, minimum upward light dispersion in the anthracite finish.

Watertight **wiring** through the supplied cable that powers the integrated driver. Further M16 entry for additional wiring, positioned in the lower part of the closing cap in technopolymer.

Robust and versatile

The versatility of OLLIE's installation is divided into three heights of extruded aluminum poles available for different lighting scenarios, with a robust and simple mounting.

SPECIFICATION SHEET

Luminart®

WWW.LUMINARTLIGHTING.COM

T-LUX™ OLLIE

BOLLARD - LIGHT BODY

TYPE:

PROJECT NAME:



anthracite



aluminum grey



aluminum grey + anthracite



anthracite + aluminum grey



bronze

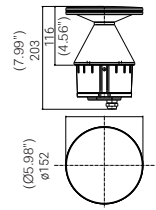

Code

Lamp

W

Lm LED

Real Lm

Optic

L985553		AN - anthracite	27K - 2700K 3K - 3000K 4K - 4000K
		AG - aluminum grey	
		AGAN - aluminum grey + anthracite	
		ANAG - anthracite + aluminum grey	
		BR - bronze	

LED	12,5	1725	968	diffuse
-----	------	------	-----	---------

Cable supplied



SPECIFICATION SHEET

T-LUX™ OLLIE

BOLLARD

TYPE:

PROJECT NAME:

LIGHT BODY



anthracite



aluminum grey



aluminum grey + anthracite



anthracite + aluminum grey



bronze

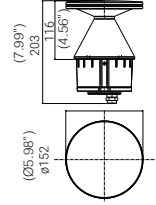

Code

L985553		AN - anthracite	27K - 2700K 3K - 3000K 4K - 4000K
		AG - aluminum grey	
		AGAN - aluminum grey + anthracite	
		ANAG - anthracite + aluminum grey	
		BR - bronze	

Lamp

W

Lm LED

Real Lm

Optic

LED	12,5	1725	968	diffuse
-----	------	------	-----	---------

POLES



anthracite



aluminium grey



bronze

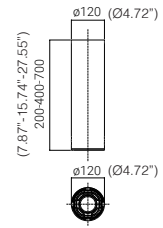

Code

H

Description

L983601		AN - anthracite	7.87" (200 mm)	Smooth pole in extruded aluminum with incorporated internal fixing base in die-cast aluminum
L983602		AG - aluminum grey	15.74" (400 mm)	
L983603		BR - bronze	27.55" (700 mm)	

PLATE WITH ANCHORING SET

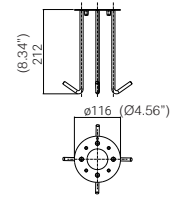

Code

Description

L985538	Stainless steel plate with ground anchoring set
---------	-------------------------------------------------

ORDERING INFO

Model Code	Light Body Finish	LED	Pole Length	Pole Finish	Plate	Dimming Options
<input type="radio"/> L985553	<input type="radio"/> AN: Anthracite <input type="radio"/> AG: Aluminum Gray <input type="radio"/> BR: Bronze <input type="radio"/> AGAN: Aluminum Gray + Anthracite <input type="radio"/> ANAG: Anthracite + Aluminum Gray	<input type="radio"/> 27K: 2700K <input type="radio"/> 3K: 3000K <input type="radio"/> 4K: 4000K	<input type="radio"/> L983601: 7.87" <input type="radio"/> L983602: 15.74" <input type="radio"/> L983603: 27.55"	<input type="radio"/> AN: Anthracite <input type="radio"/> AG: Aluminum Gray <input type="radio"/> BR: Bronze	<input type="radio"/> L985538	<input type="radio"/> 120V <input type="radio"/> 277V



SPECIFICATION SHEET