

TYPE:

PROJECT NAME:

WIRING DIAGRAM

DIMMING 120V ONLY
TRIAC / ELV (LTE)

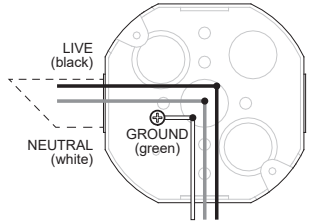

FIXTURE CABLES

WIRING DIAGRAM

DIMMING 120-277V
0-10V (D10)

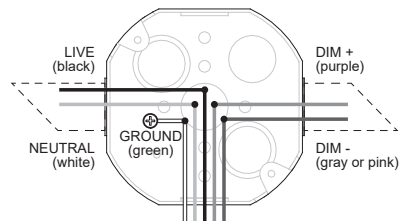

FIXTURE CABLES

*Junction box for reference only

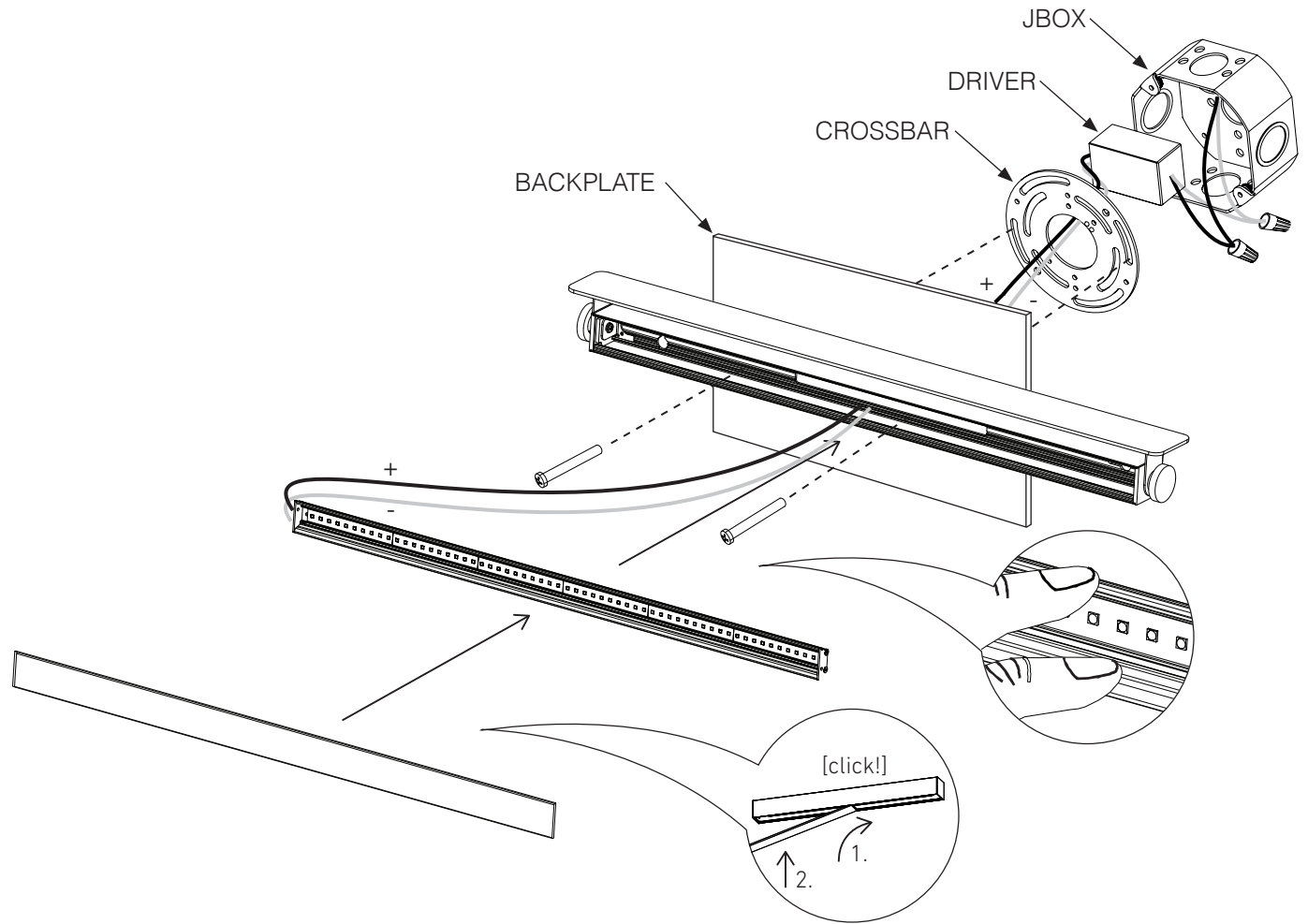

- Make the wiring connections between the fixture and driver by following the wiring diagram.
- Put the driver into junction box, and install the crossbar to the junction box.
- Attach the fixture with backplate to the crossbar with screws.
- Push the strip with the LED module into the housing. Make sure that the bar is placed parallel to the housing. Be careful not to crush the LEDs. In order to disassemble the reflector, lift the bar with a screwdriver at the milling point, leaning the tool against the protected edge of the housing.
- Install the diffuser in the luminaire:
 1. Half the length of the lamp press the end of the diffuser to profile, and then insert.
 2. Press the other end of the diffuser. To pull out, gently pry with a plastic object and push out.