

FREEDOM LINE™

INSTALLATION INSTRUCTIONS

TYPE:

PROJECT NAME:

- 1 LAY THE SYSTEM ON THE FLOOR LEVEL, AND MARK THE BRACKET POSITIONS ON THE CEILING BY USING LAZER POINTER.

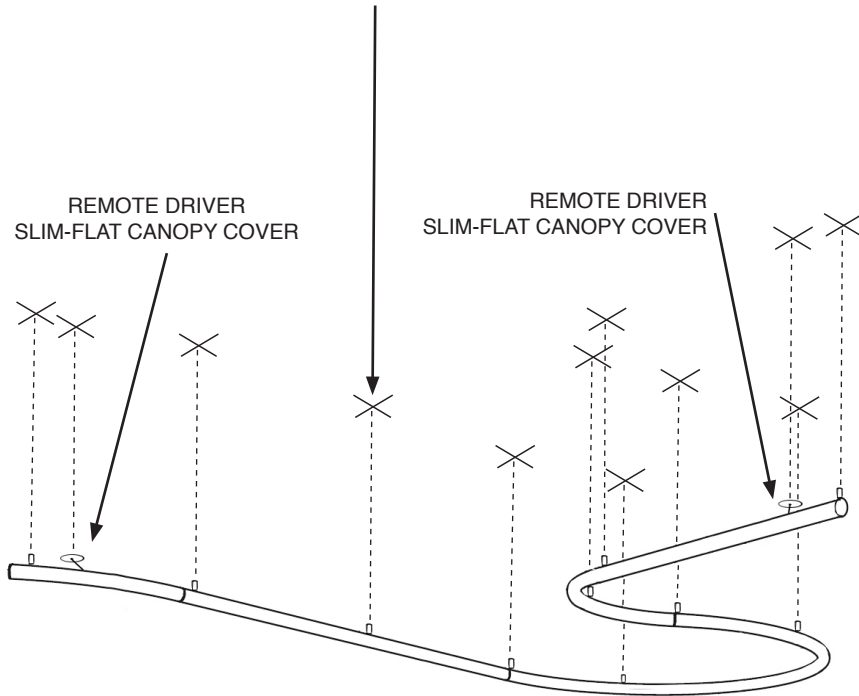

IMPORTANT:

- ALL SECTIONS MUST BE LEVELLED HORIZONTALLY.
- ALL GRIPPERS MUST BE POSITIONED PERFECTLY VERTICAL.
- LEVEL ALL SECTIONS BY ADJUSTING THE MOUNTING BRACKET.
- IF THESE CONDITIONS ARE NOT SATISFIED THEN THE DIFFERENT SECTIONS WILL SETTLE TO DIFFERENT LEVELS.
- **DO NOT POWER THE FIXTURE BEFORE ALL SECTIONS ARE PROPERLY INSTALLED.**

- 2 MOUNT CEILING MOUNT BRACKET TO MARKED POSITIONS ON THE CEILING.

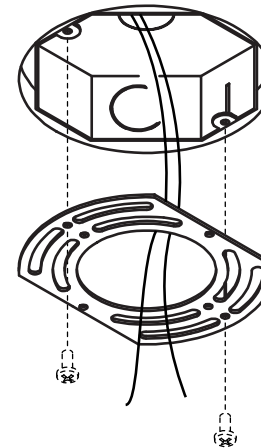
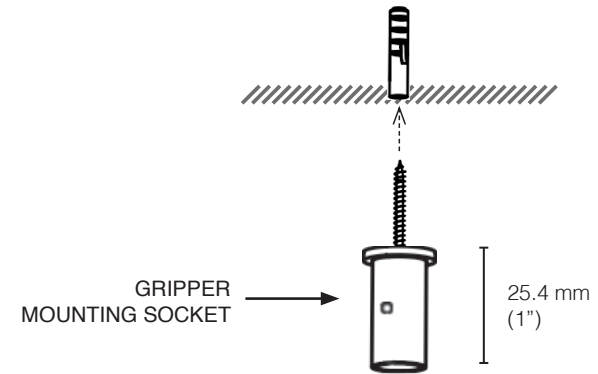

ROUGH IN THE JBOX PER YOUR DESIGN LOCATION.

- 3 MOUNT CEILING MOUNTING BRACKET TO MARKED POSITIONS ON CEILING. INSTALL THE STAND OFF PIN INTO THE MOUNTING BRACKET, AND SCREW THE SET SCREW TO LOCK THE SECTION TO THE CEILING.

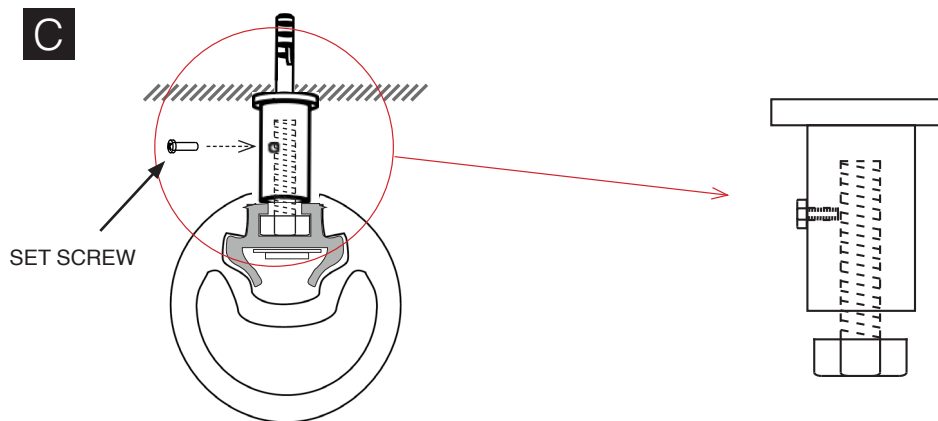
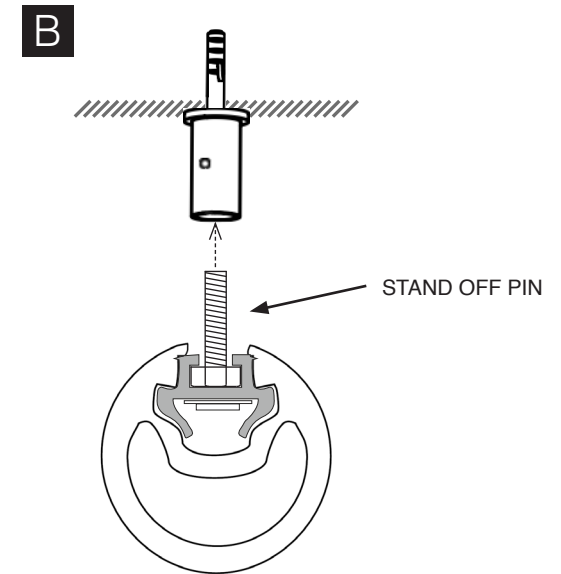
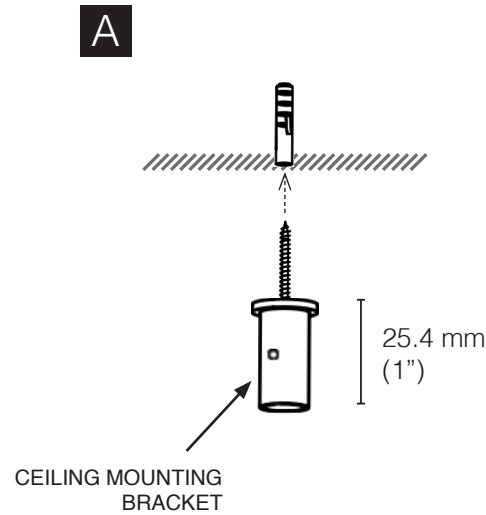
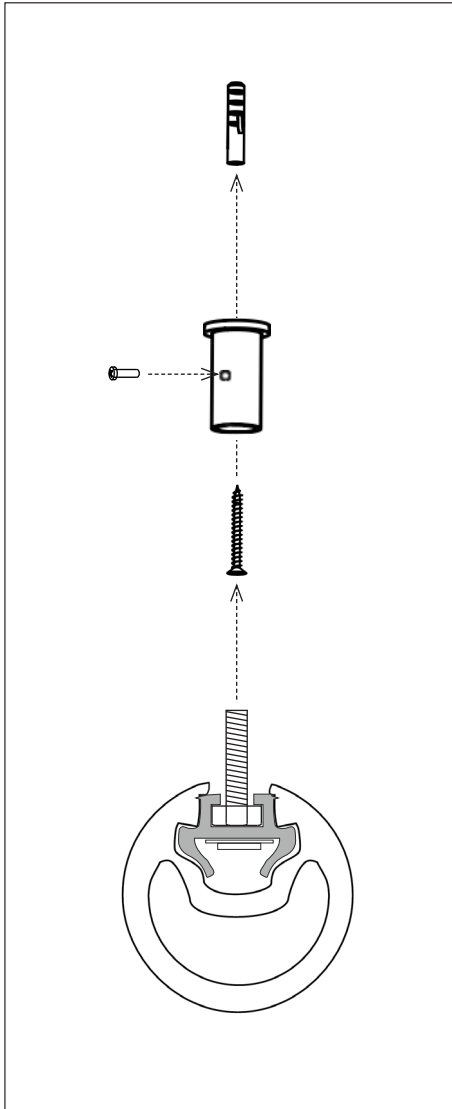

4

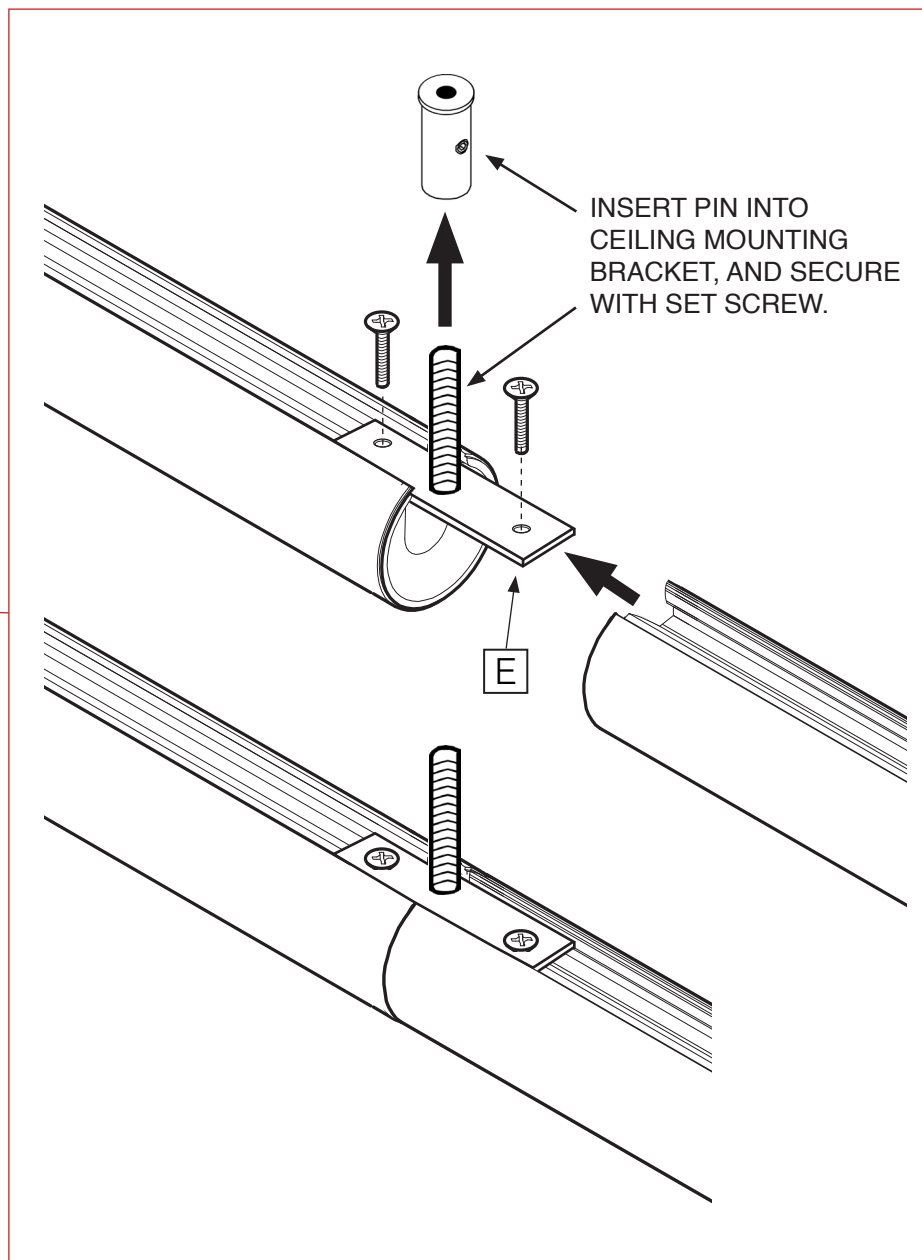
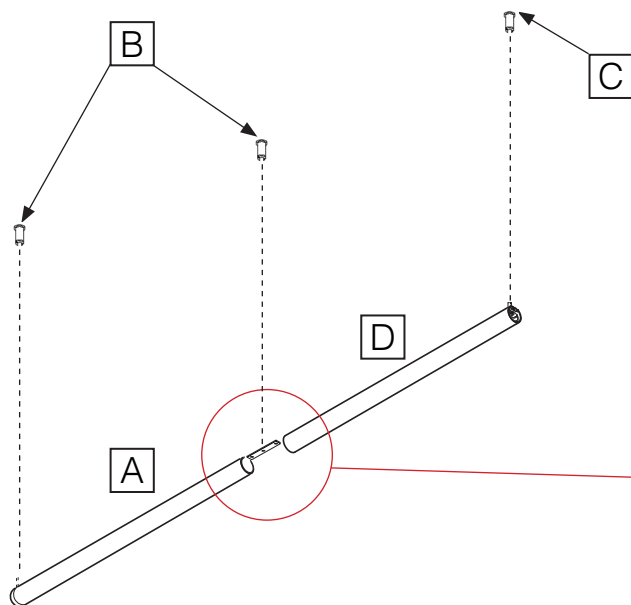

- MAKE THE CONNECTIONS BETWEEN MODULE SECTIONS, AND INSTALL THE SECTIONS ONE AT A TIME.
- MAKE SURE THE FIRST SECTION (A) HAS THE CEILING BRACKET (B) INSTALLED, AND THE SECTION IS SUPPORTED.
- MOUNT THE NEXT CEILING BRACKET (C) TO THE MARKED POSITION.
- CONNECT SECTION (D) TO SECTION (A) BY USING THE CONNECTOR BRACKET (E). AND SCREW THE CONNECTOR TO THE SECTIONS.
- **DO NOT POWER THE FIXTURE BEFORE ALL SECTIONS ARE PROPERLY INSTALLED.**

5

REMOTE DRIVER INSTALLATION WITH SLIM-FLAT CANOPY COVER.

REMOTE DRIVER INSTALLATION

- DO NOT POWER THE FIXTURE BEFORE ALL SECTIONS ARE PROPERLY INSTALLED.

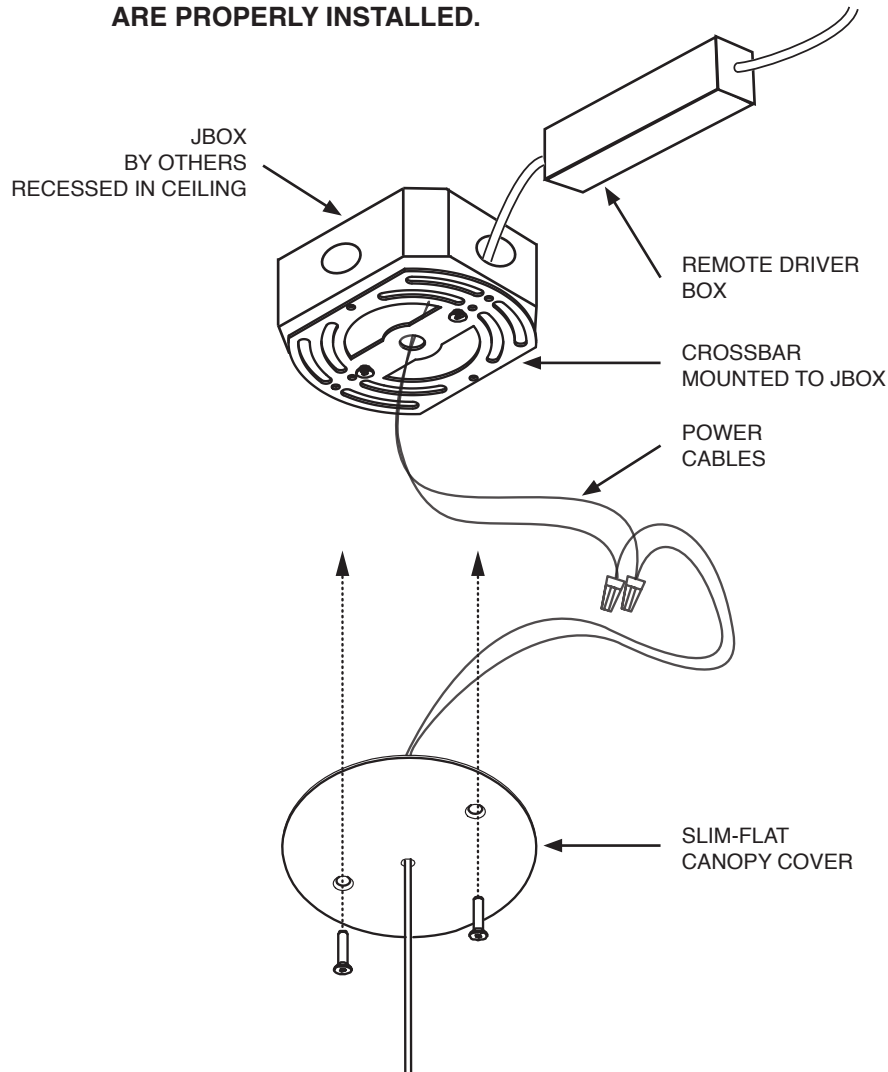

WIRING DIAGRAM

DIMMING 120V ONLY
TRIAC (LTE)

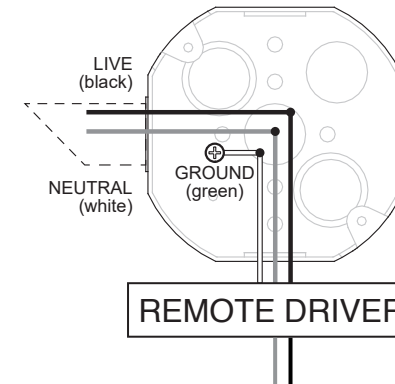

WIRING DIAGRAM

DIMMING 120-277V
0-10V

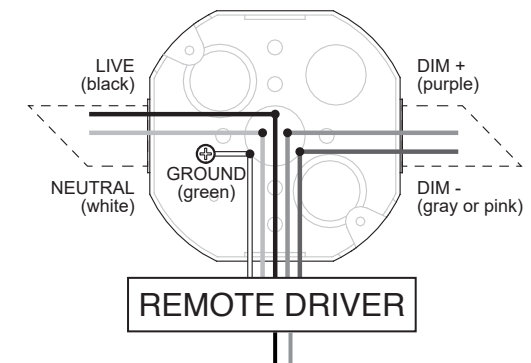

*Junction box for reference only