

**MODEL:**  
**RIGHELLO L. 160 APPLIQUE**  
**RIGHELLO L. 160 WALL LAMP**

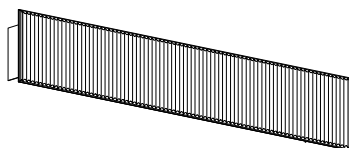
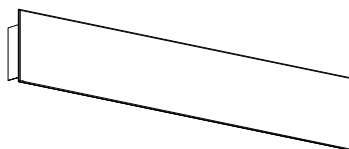
**FINISHES**



Tailor

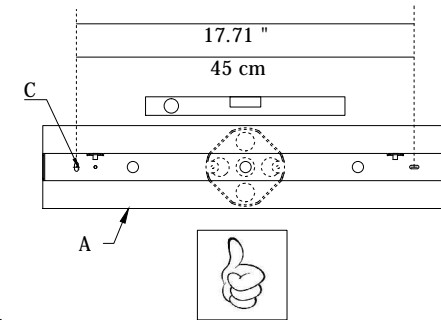
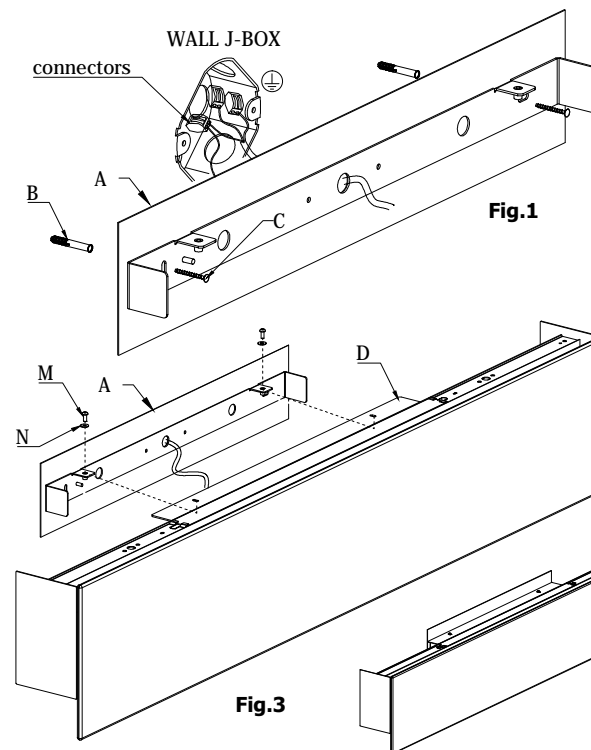


Soft textile



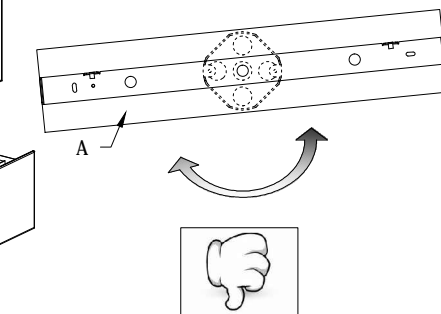
13 cm 160 cm  
 5.11 " 62.99 "

21 cm  
 8.26 "

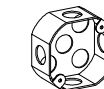


**Fig.2**

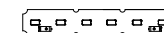
LAMP PLAN ADJUSTMENT



**STANDARD JUNCTION BOX**



green-yellow GROUND	1	
black PHASE	2	
white NEUTRAL	3	
red D1	4	0-10V
blue D2	5	WIRES



2 X Linear Led modules  
 56 W (max) 2700/3000K

**INSTRUCTION**

- Disconnect the power source.

- Connect the electrical wires:

**version on/off**

Attach black wire from Luminaire to the black supply wire

Attach white wire from Luminaire to the white supply wire

Attach green ground wire from Luminaire to the junction box

**version dim**

Attach D1 wire from Luminaire to the black supply wire

Attach D2 wire from Luminaire to the white supply wire

- Closed the junction box, fix the bracket (A) with screws (B) and plugs (C) to the wall (Fig. 1).

- Pay attention lamp plan adjustment (Fig. 2).

- Fix the canopy (D) to the bracket (A) with two screws (M) and two washers (N) (Fig. 2).

**ATTENTION**

The products of our production are suitable for the using in usual surroundings with standard temperature and humidity levels. All the operations have to be done with the power off.

**CLEANING**

**Switch off the power or pull the plug out.**

For the periodical cleaning of the lamp use always gloves and a soft cloth. Use spray for glasses or all-purpose.

Avoid absolutely to fold parts which are not expected for folding, in this case welded parts are going to be damaged.