

FREEDOM CIRCLE™

INSTALLATION INSTRUCTIONS

TYPE:

PROJECT NAME:

1

LAY THE FIXTURE ON THE FLOOR LEVEL, AND MARK THE CABLE GRIPPER POSITIONS ON THE CEILING BY USING LAZER POINTER.

IMPORTANT:

- FIXTURE COMES WITH I-JOINER BRACKET WHEN JOINING 2 SECTIONS TOGETHER.
- FIXTURE MUST BE LEVELLED HORIZONTALLY.
- ALL AIRCRAFT CABLES MUST BE POSITIONED PERFECTLY VERTICAL.
- LEVEL THE FIXTURE BY ADJUSTING CABLE LENGTHS.
- **DO NOT POWER THE FIXTURE BEFORE ALL SECTIONS ARE PROPERLY INSTALLED.**

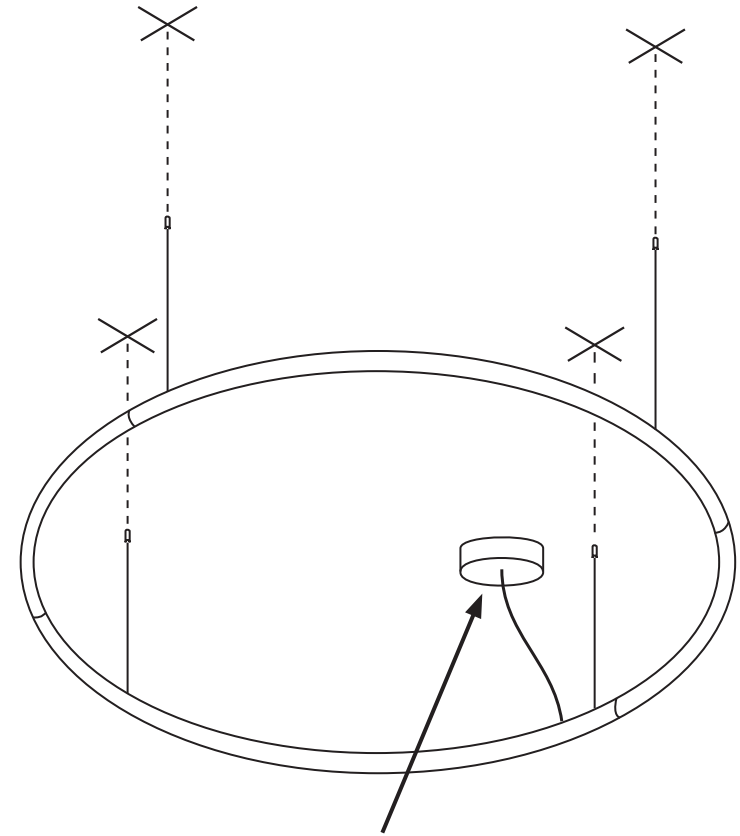

INTEGRAL DRIVER
SURFACE MOUNT CANOPY

FREEDOM CIRCLE™

INSTALLATION INSTRUCTIONS

TYPE:

PROJECT NAME:

- 2** MOUNT CABLE GRIPPER SOCKETS TO MARKED POSITIONS ON THE CEILING AND SCREW THE GRIPPERS IN.

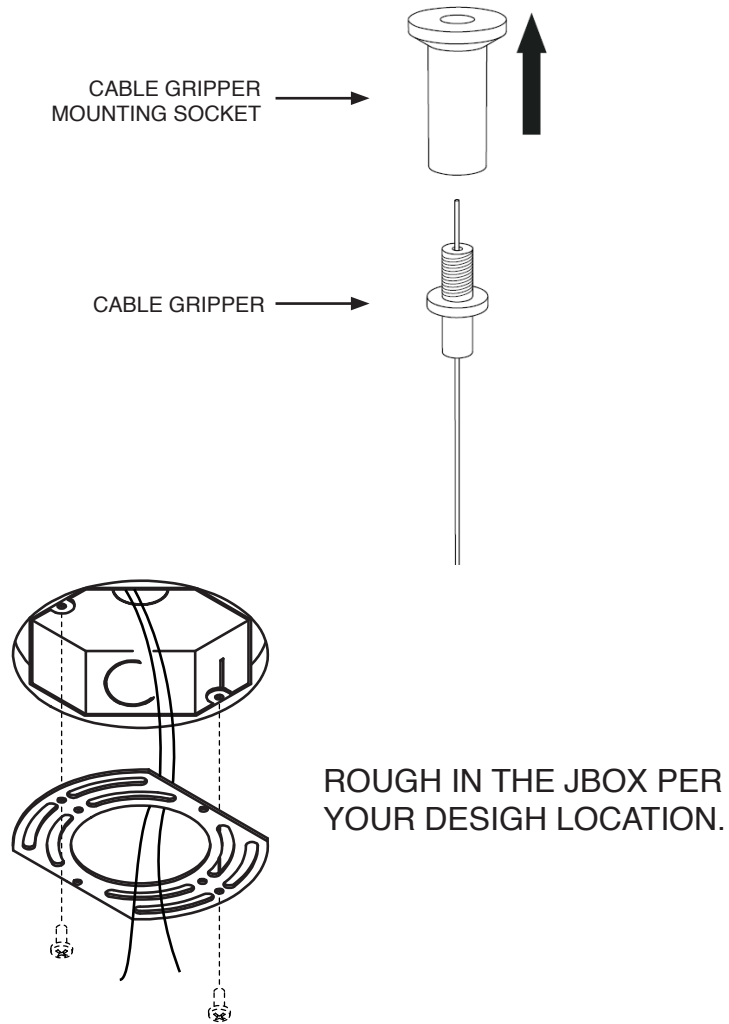

- 3** **INSTALLATION NOTE:** FIXTURE COMES WITH I-JOINER BRACKET WHEN JOINING 2 SECTIONS TOGETHER.

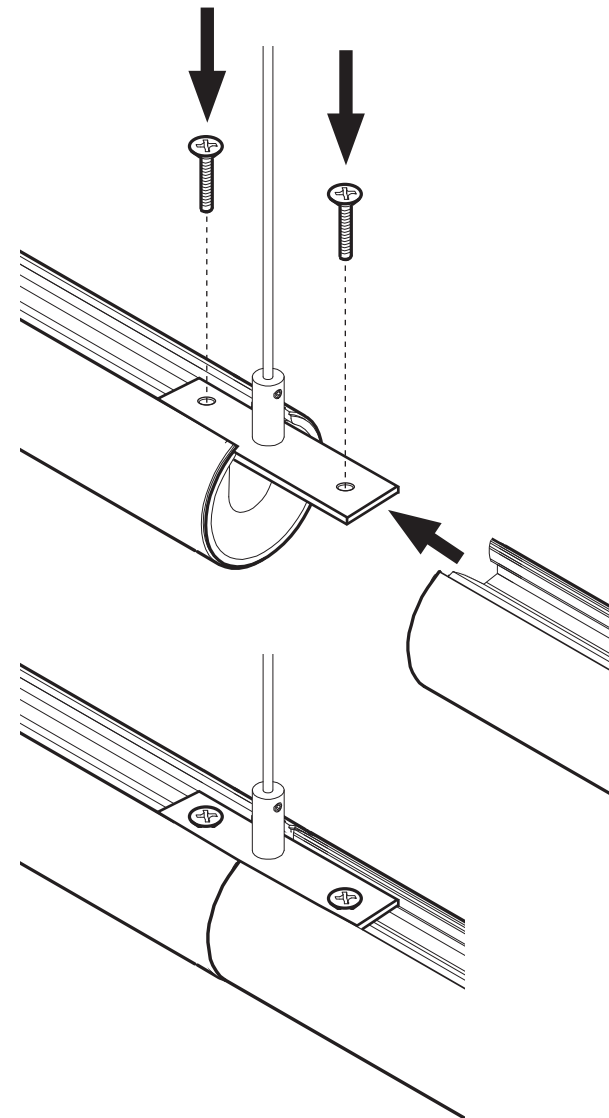

4a

REMOTE DRIVER INSTALLATION WITH SLIM-FLAT CANOPY COVER.

REMOTE DRIVER INSTALLATION

- DO NOT POWER THE FIXTURE BEFORE ALL SECTIONS ARE PROPERLY INSTALLED.

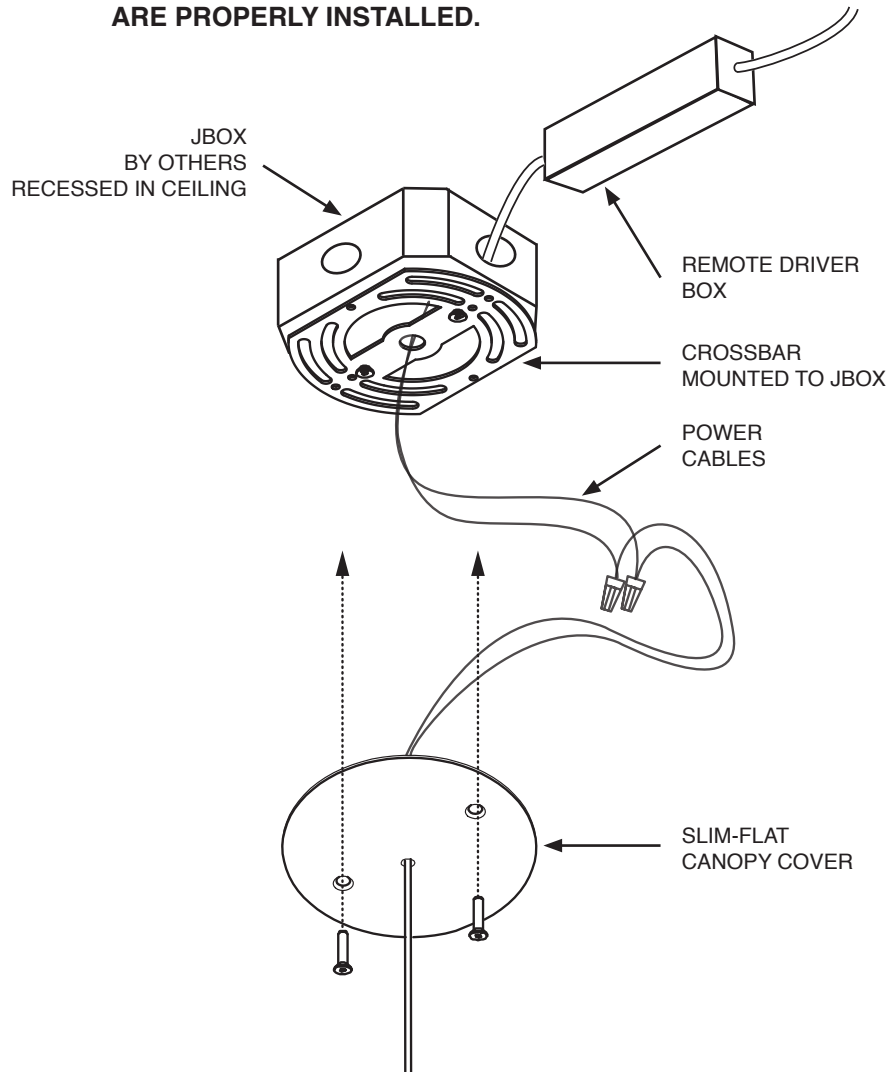

WIRING DIAGRAM

DIMMING 120V ONLY
TRIAC (LTE)

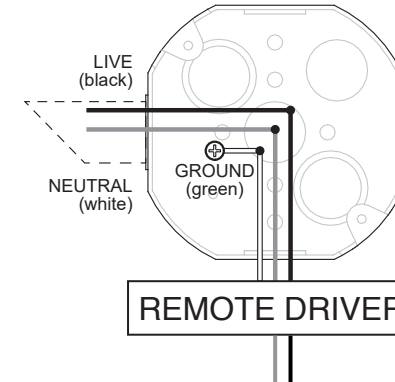

WIRING DIAGRAM

DIMMING 120-277V
0-10V

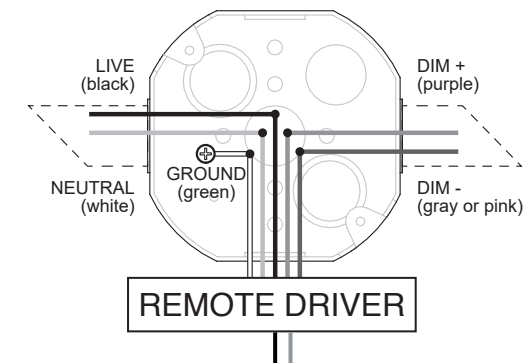

*Junction box for reference only

4b

INTEGRAL DRIVER INSTALLATION WITH SURFACE MOUNT DRIVER CANOPY.

INTEGRAL DRIVER INSTALLATION

- DO NOT POWER THE FIXTURE BEFORE ALL SECTIONS ARE PROPERLY INSTALLED.

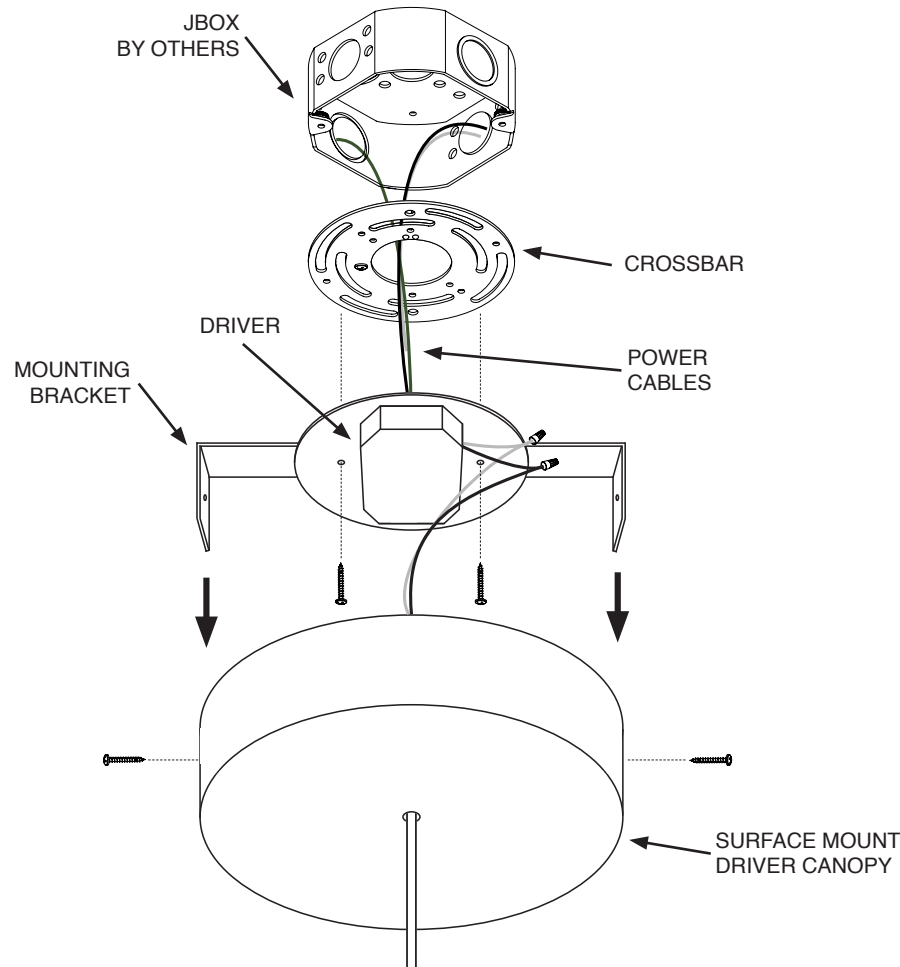

WIRING DIAGRAM

DIMMING 120V ONLY
TRIAC (LTE)

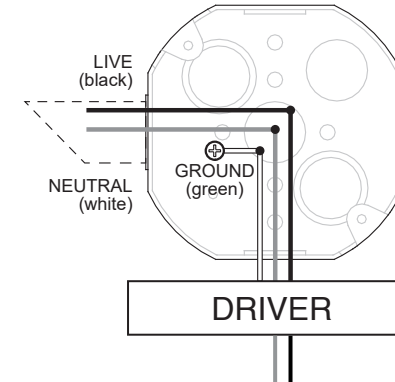

WIRING DIAGRAM

DIMMING 120-277V
0-10V

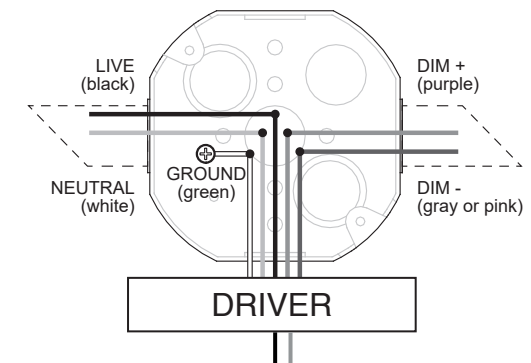

* Junction box for reference only