

SESTANTE WALL

INSTALLATION INSTRUCTIONS

TYPE:

PROJECT NAME:

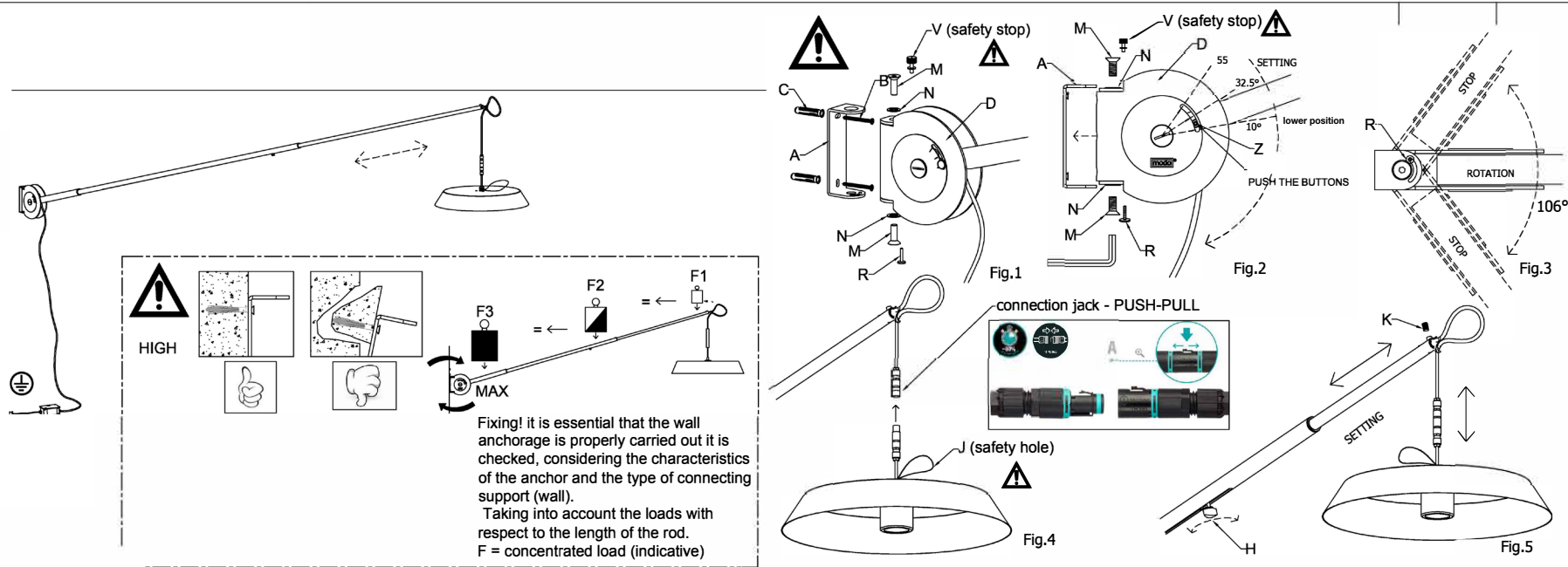

INSTRUCTION

- Disconnect the power source.
- Fix the bracket (A) with screws (B) and wall plugs (C) on the wall (Fig. 1).
- Fix the structure (D) to the bracket (A) with two screws (M) interposing the two washers (N) between the bracket (Fig. 2).
- Particular x rotation limit, screw the grain (R) (Fig. 2 + 3).
- Install the LED Diffuser (R), via the PUSH-PULL plug-in jack connector (Fig. 4)

ADJUSTMENTS

- Adjust the angle of the lampshade rod by acting on the pins (Z), compressing and releasing in the desired position (Fig. 2)
- Adjust the lamp's rod length by acting on the screw (H). (Fig. 5)
- Adjust the height of the lampshade by acting on the cable clamp (K) by sliding the cable inside the profile. (Fig. 5)

SETTING IN SAFETY (SEE INSERTED INSTRUCTION SHEET)

- Place the rod in the lowest position (fig. 4)
- locking detail (V), screw in the 3 positions in case of bad weather (Fig.1)
- The diffuser is equipped with a slotted cord x anchorage to the rod (J). (Fig.4)
- Removal of the led diffuser through rapid disconnection PUSH-PULL (Fig.4)

ATTENTION

The products of our production are suitable for the using in usual surroundings with standard temperature and humidity levels.
All the operations have to be done by a technician.



1X Led Cob
18 W 2700/3000K

PROCEDURE TO SECURE THE LAMP DURING INCLEMENT WEATHER

WARNINGS IN CASE OF WEATHER

read carefully and keep the assembly instructions and the user manual. the relevant information must be absolutely respected.

the client is required to observe the weather forecasts and in the case of bad weather warnings, to take the necessary safety measures, if necessary until the lamp is dismantled.

STEP 1/2

Safety at wind risk must be carried out in a few minutes after the announcement of weather conditions.

STEP3.

In the event of exceptional weather events the lamp must be dismantled in a short time and made safe at any time.

Remember that sudden gusts of wind can damage the lamp.

Always remember that the lamp is not a fixed structure.

The disassembly operations can also be performed independently, provided they are followed carefully according to the instructions attached to the product.

STEP 1

- Disconnect the power source.
- Shorten the shade rod at the end of its travel and tighten the knob X

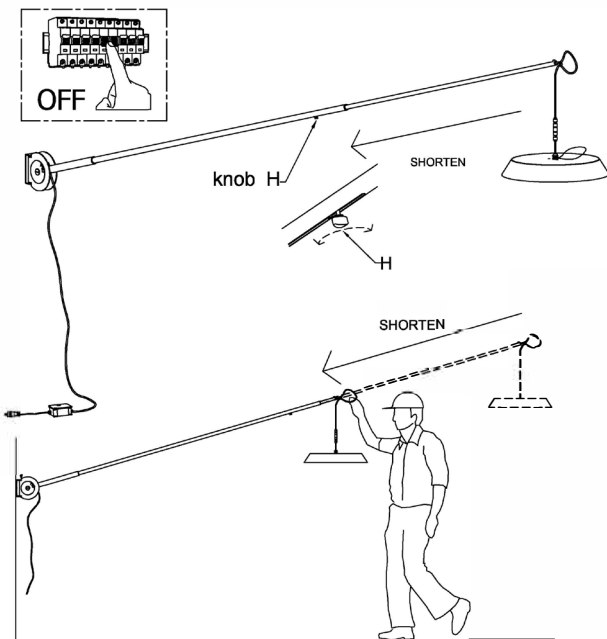

STEP 2

- Place the rod in the lower position.
- Lock the lamp by screwing the screw part (V) into the 3 holes provided to ensure stability and safety.

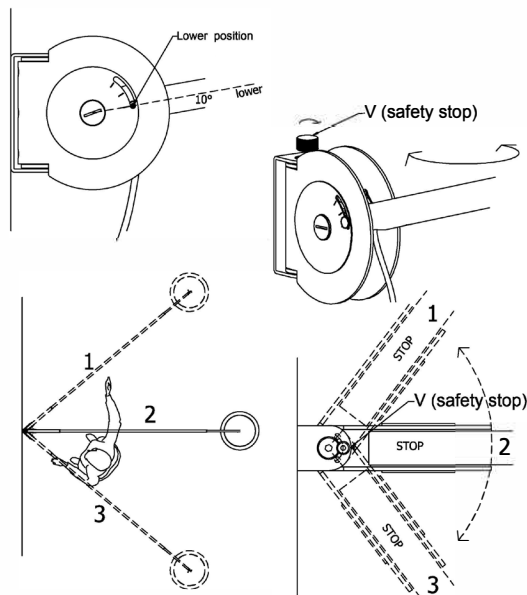

STEP 3

- Disconnect the connection and remove the LED diffuser, and place it in a safe place.

