

BRICK

WALL

TYPE:

PROJECT NAME:

SPECIFICATION SHEET



Luminart®

WWW.LUMINARTLIGHTING.COM

BRICK

WALL

TYPE:

PROJECT NAME:

BRICK G9

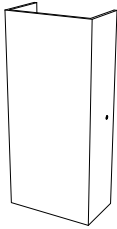

LAMP TYPE	RETROFIT LED
FITTING	G9
WATTAGE	2x5W
VOLTAGE	120V

ORDER CODE

ALUMINUM	L30T33A1HAB
BLACK	L30T33A1HZL
CHROME	L30T33A1HAP
WHITE	L30T33A1HWL

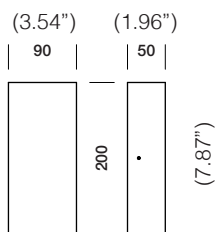

BRICK LED

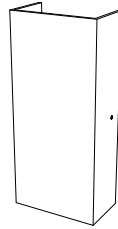

LAMP TYPE	LED
COLOUR TEMP.	2700K
WATTAGE	6W + 6W
VOLTAGE	120V

ORDER CODE

ALUMINUM	L30T33A1DAB
BLACK	L30T33A1DZL
CHROME	L30T33A1DAP
WHITE	L30T33A1DWL

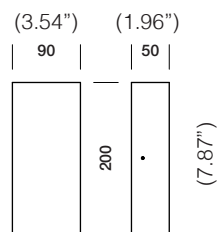

BRICK H

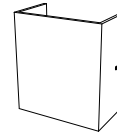

LAMP TYPE	RETROFIT LED
FITTING	G9
WATTAGE	5W
VOLTAGE	120V

ORDER CODE

ALUMINUM	L30T33A2HAB
BLACK	L30T33A2HZL
CHROME	L30T33A2HAP
WHITE	L30T33A2HWL

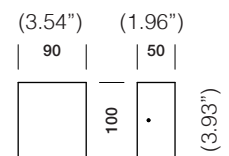

Installation Options

Octagon J-Box Installation with Backplate
For installation on a standard junction box, fixture includes a 4" backplate.

Switchbox Installation
Alternate installation: if installed on a 2" switch-type junction box, backplate is not needed.

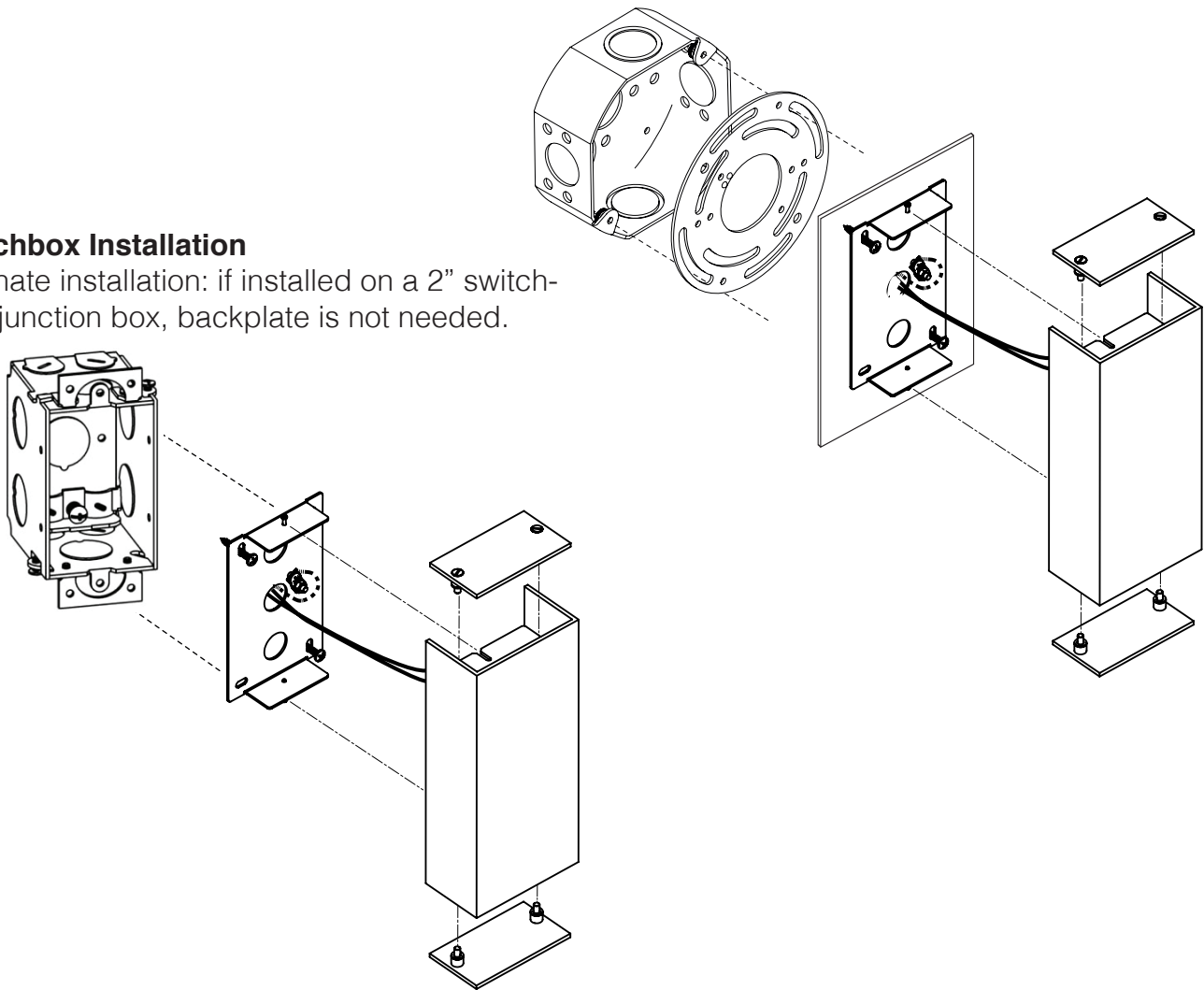

ORDERING INFO

Model (Order Code)	Installation Option	Power Options
	<input type="radio"/> Octagon J-Box with Backplate	<input type="radio"/> 120V Phase Dimming
	<input type="radio"/> Switchbox with No Backplate	<input type="radio"/> 120V 0-10V Dimming (Integral LED only)
		<input type="radio"/> 277V 0-10V Dimming (Integral LED only)

